

Bucket Elevator Components

Engineered for Agricultural and Industrial Applications

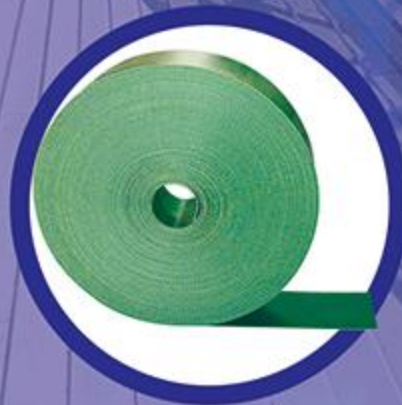

SPEC SHEET CATALOGUE

JIANGSU JINGWEI CONVEYING EQUIPMENT CO.,LTD
ZHENJIANG JINGWEI PLASTIC&RUBBER CO., LTD



Company Profile

JIANGSU JINGWEI CONVEYING EQUIPMENT CO. LTD., Established in 2011, specializing in bucket elevator, conveyor parts manufacturing, in recent years, more than 10 research and development of food conveying accessories obtained national invention and edible new patents.

Our factory, covering 28,000 square meters, is located in Daoshu Industrial Park, Danyang City, Jiangsu Province, which is one of the most developed industrial areas in China. The company covers 28,000 square meters with the floor area of 8,000 square meters.

Our main products include elevator bucket, drag conveyor flight, UHMW-PE sheet, PVC elevator belts, elevator bolts, belt fastener, conveyor chains and more than four hundred types components which are widely used in bulk material handling and storage industry. JINGWEI currently has more than ten units of the whole series of 250-2500g injection molding machines, production lines for conveyor chains, elevator bolts and the accessories, and UHMW-PE sheet with stronger resistance to pressure than its domestic counterparts, and a special one for PVC solid woven belt. Our annual output for elevator buckets can reach 5 million, with 2 million for steel buckets, 500 tons of UHMW-PE products, 0.8 million square meters of PVC solid woven elevator belt, 15 billion sets of elevator bolts, and 60,000 meters of conveyor chains.

Our company is strictly in accordance with ISO9001 Quality Management System, and has obtained SGS certification. In an effort to raise work efficiency and lower cost of production, JINGWEI has introduced ERP system to better manage product information, on the base of that, we have the ability to provide high quality products with competitive price and best service to customers.

JINGWEI believes the enterprise spirit of "integrity, pragmatic and innovative."

The enterprise spirit of JINGWEI is "integrity, practicability and innovation". We will strive to become one of the best one-stop suppliers in the industry.

Zhenjiang Jingwei Plastic & Rubber Co., Ltd is a sales company of Jiangsu Jingwei Conveying Equipment Co., Ltd, We have an excellent foreign trade sales and service team, serving customers from over 50 countries in Southeast Asia, Europe and America And regions.



CONTENTS

01

Bucket Elevator Components

Bucket Options Guidance	1-2
Plastic Bucket	3-10
Whole Stamping Steel Bucket	11-13
PVC Elevator Belt	14
Reformed rubber elevator belt	15
Elevator Bolt	16-17
Belt Clamp Fastener	18
Lagging pads	19

02

Drag Conveyor Components

Chain	20-22
Drag conveyor flight	23
Nylon gear wheel	24
Sprocket	25

03

Engineering Plastic

UHMW-PE	26
PU	27
Cast Nylon (MC Nylon)	28
PTFE	28
Non-standard board Customization	29

04

Conveyor Equipment Components

EP Conveyor Belt	30
Patterned Conveyor Belt	31
Light & Thin Conveyor Belt	32

05

Screw Conveyor Components

Continuous screw flight	33
Sectional screw flight	34

06

Sieve Cleaner and Pan Cleaner

Sieve cleaners	35
Pan cleaners	35
Rubber ball	36

Elevator Buckets

OUR BUCKETS' FEATURE

- Resistant to high impact, abrasion and corrosion with smooth surface, compliant with FDA Food proved.
- Less weight, prolong service life of buckets and belts, reduce energy costs of elevators.
- Good toughness, lower rate of breakage for material, no-sparking nor dust explosion.
- A dozen of buckets with different styles and sizes available.
- Higher cost performance than traditional cast iron bucket.



Bucket Material Options

Material	Applied range	Cost	Operating temperature	Wear resistance	Impact resistance	FDA Food approved	Colour
HDPE reinforced	Cereals and food products	*	-30°C~70°C	*	*	✓	White
NYLON reinforced	Heat-resistance and sturdy industrial products	***	-25°C~100°C	**	***	✓	Milk white
Mild steel	General purpose, long lifespan, cereals and industrial products	***	-40°C~180°C	***	***	✓	Grey
Stainless steel	Food grade, highly corrosive and high temperature resistance products	****	-50°C~250°C	***	***	✓	Silver

Measure an Elevator Bucket & Product Usage Recommendations.

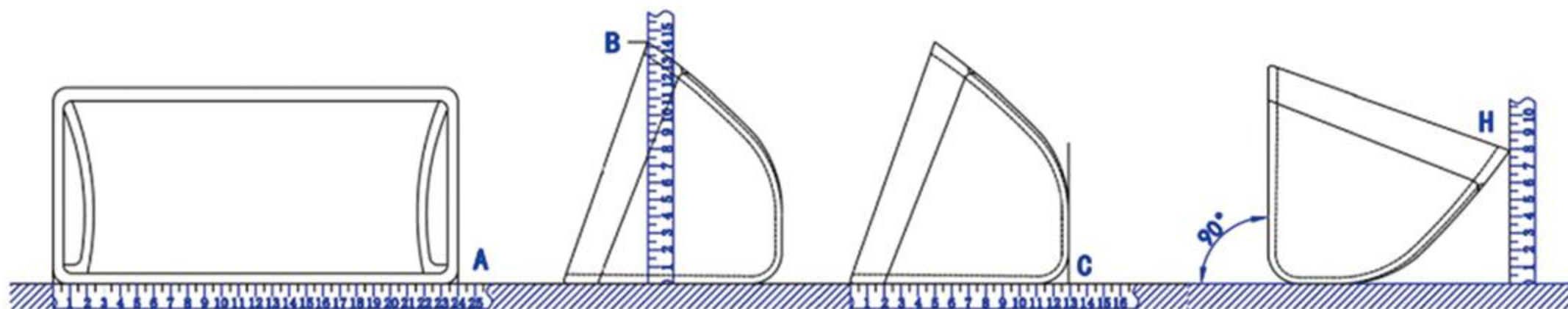

ELEVATOR BUCKET VENTING HOLES

- The bottom hole can improve the filling coefficient. When unloading, the air is returned through the opening, so it can prevent the production of vacuum so as to suck in some materials and produce the phenomenon of material return.
- For especially light loading materials, such as alfalfa powder, sieve dust, and bran, the venting holes not only minimizes material loss during loading and unloading, but also reduces air confusion and airflow in the hoist barrel, greatly reducing the flow of these light materials back to the bottom.
- A variety of venting modes are available according to customer requirements.

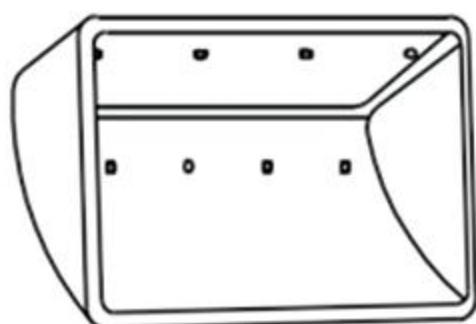

Type 1

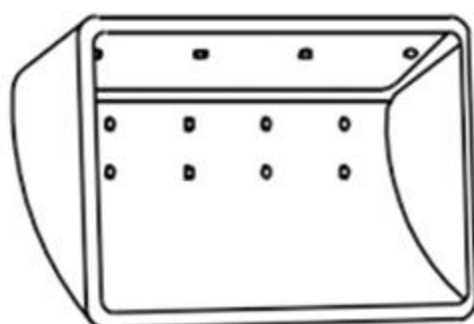

Type 2

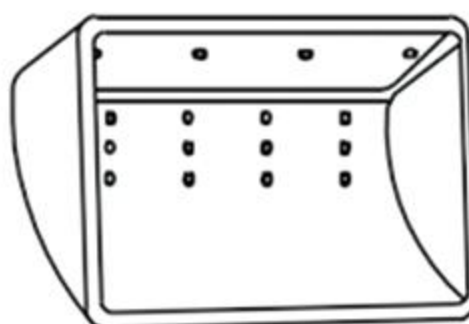

Type 3

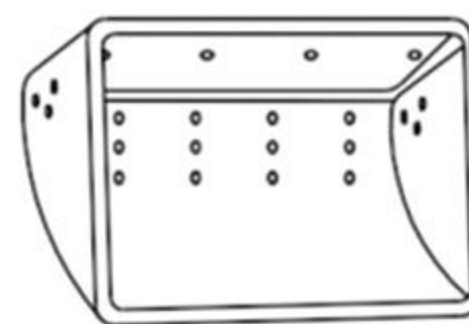

Type 4

All Series Bucket Options (HDPE & NYLON & Steel)



D and S Series (Deep)



DS Series (Deep)



DS Series (Deep/steel)



CC Series (Deep)



M Series (Mid-deep)



DQ Series (Shallow /Steel)



DQ Series (Shallow)



E Series (Shallow)



DH Series (Drying bucket)



DX Series (Rice Mill Bucket)



DM Series (Rice Mill Bucket)



DL Series (Inductive Bucket)

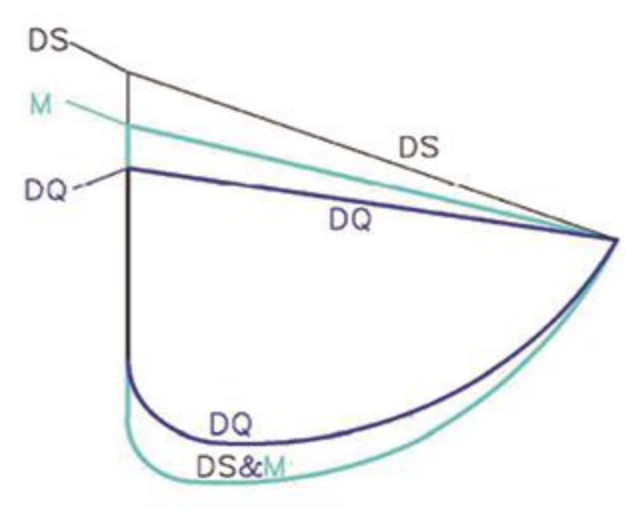
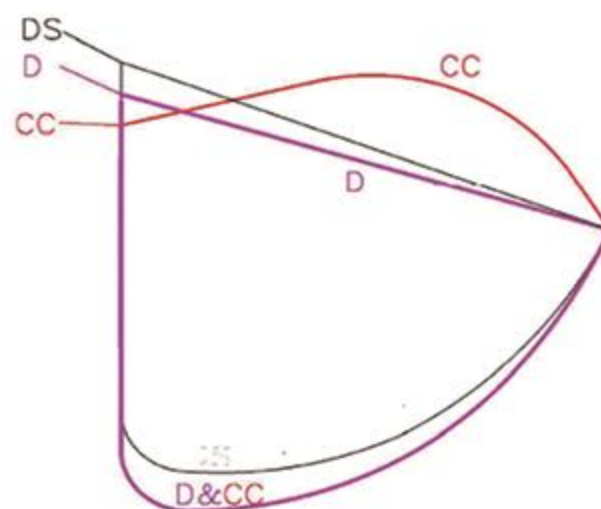
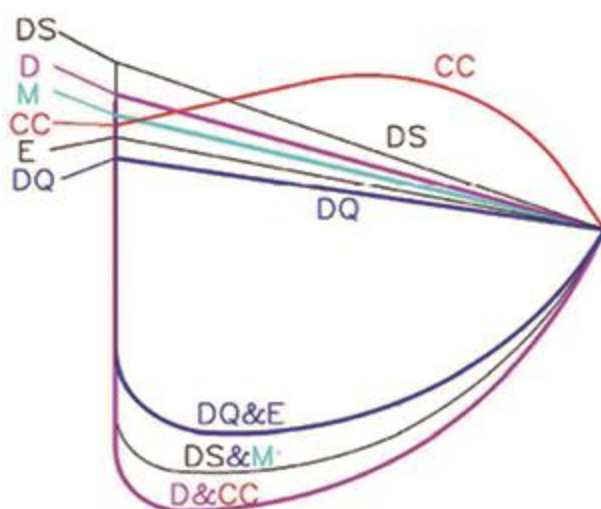

Full series of line comparisons

D and S Series Deep Type Bucket (HDPE & NYLON)

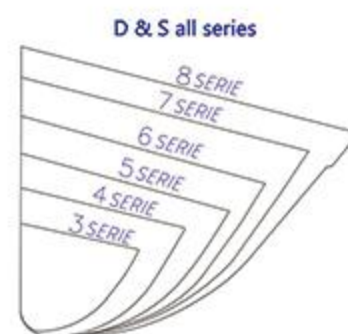
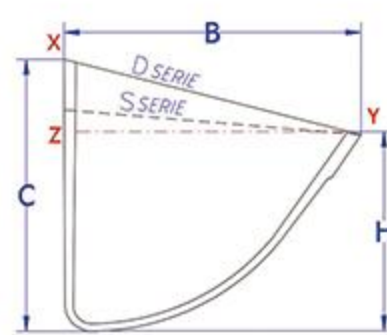
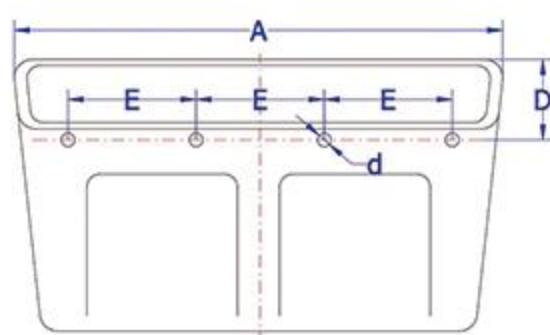

- D and S series belong to heavy agricultural type deep bucket. It is also an improved and thickened version of the DS series.
- According to north American prototype bucket of this series, combined with domestic elevator bucket design characteristics and our design concept.
- This series can be used interchangeably with foreign HD/CC winnowing pan series, The S series has a lower back height than the D Series.
- Recommended minimum bucket distance is size "B"+ 25 mm size, can be adjusted according to request of lifting capacity winnowing pan installation spacing;
- It is recommended that the linear speed of the elevator be less than 2.5 m/s. Can be adjusted according to the size of the head wheel diameter of the elevator, as well as the change of grain Angle.
- Recommend using (Z-Y)+10% as usable capacity for engineering design.

The data in the table is based on HDPE material, and the corresponding data of nylon material is +1.5% on this basis)

[illegible]

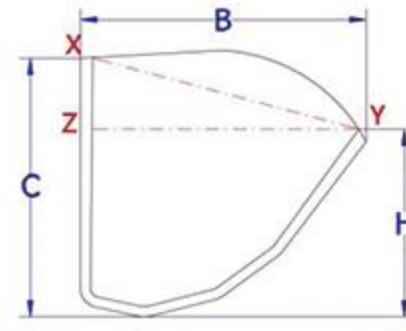
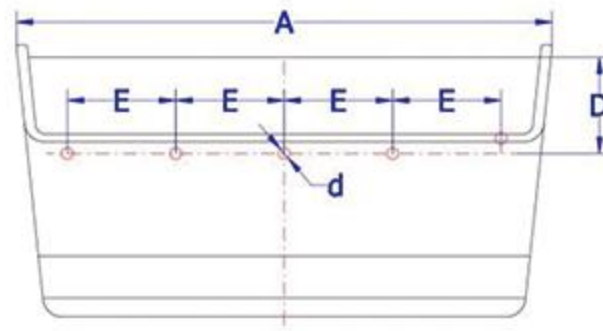

- The data in the table is based on HDPE material, and the corresponding data of nylon material is +1.5% on this basis)

[illegible]

DS Series Deep Type Bucket (HDPE & NYLON)

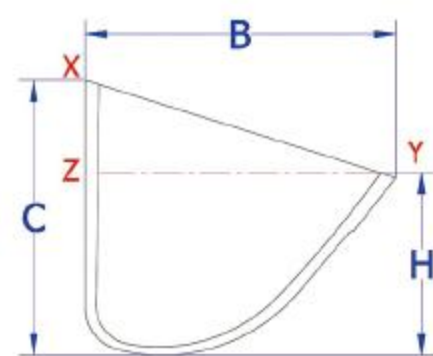
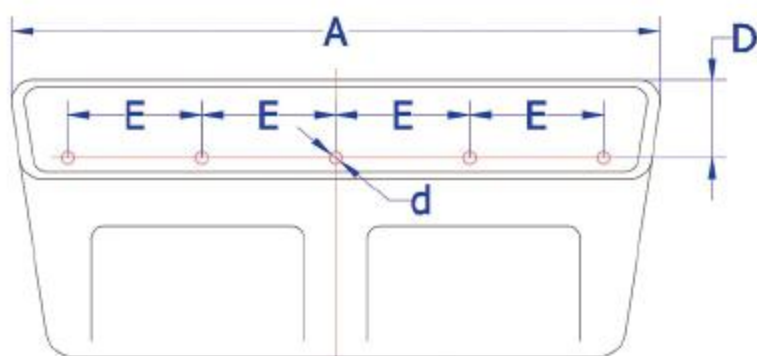

- Suitable for gravity discharge or mixed discharge.
- Recommended minimum bucket distance is size "B" + 25 mm size, can be adjusted according to request of lifting capacity.
- It is recommended that the linear speed of the elevator be less than 2.5 m/s. Can be adjusted according to the size of the head wheel diameter of the elevator, as well as the change of grain Angle.
- Recommended "(Z-Y) + 10% "volume as available capacity of the engineering design.

The data in the table is based on HDPE material, and the corresponding data of nylon material is +1.5% on this basis)

[illegible]

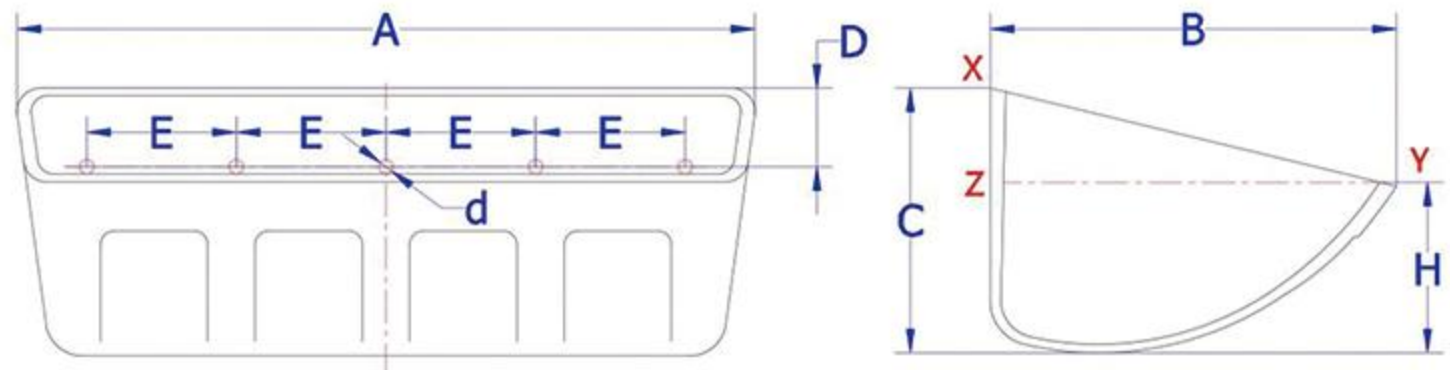

- The data in the table is based on HDPE material, and the corresponding data of nylon material is +1.5% on this basis)

Model	Length A (mm)	Proj. B (mm)	Depth C (mm)	Height H (mm)	Distance D (mm)	Center E (mm)	Holes num	Hole dia d (mm)	Capacity (Z-Y)+5% (L)	Capacity (Z-Y) (L)
DQ1009	106	93	66	47	25	50	2	7	0.22	0.21
DQ1311	136	118	72	39	25	60	2	7	0.32	0.30
DQ1312	135	117	85	62	30	60	2	7	0.64	0.61
DQ1613	168	135	85	55	25	90	2	9	0.79	0.75
DQ1814	185	145	87	65	30	100	2	9	0.84	0.80
DQ1914	190	147	112	68	35	100	2	9	1.31	1.25
DQ2314	235	142	96	65	30	120	2	9	1.47	1.40
DQ2315	235	155	91	68	30	120	2	9	1.68	1.60
DQ2316	235	160	97	59	35	120	2	9	1.47	1.40
DQ2417	242	178	115	77	40	120	2	9	2.36	2.25
DQ2814	287	143	94	69	30	90	3	9	1.79	1.70
DQ2815	280	155	91	66	30	90	3	9	2.21	2.10
DQ2816	285	165	108	71	35	90	3	9	2.10	2.00
DQ2817	280	173	121	75	40	90	3	9	2.31	2.20
DQ2824	280	244	170	125	45	100	3	9	5.25	5.00
DQ3216	319	158	111	74	35	80	4	9	2.20	2.10
DQ3321	330	215	140	89	40	85	4	9	4.43	4.22
DQ3325	331	256	166	104	50	85	4	9	6.90	6.60
DQ3823	382	230	165	109	45	100	4	9	6.40	6.10
DQ4423	447	230	163	107	45	90	5	9	7.25	6.90
DQ4723	475	230	163	116	45	95	5	9	7.67	7.30
DQ4726	468	258	170	110	50	95	5	11	8.72	8.30
DQ5626	560	258	175	107	50	115	5	11	11.10	10.60
Remark	Fitting holes and hole diameter canbe customized									

M Series Medium Deep Type Bucket (HDPE & NYLON)

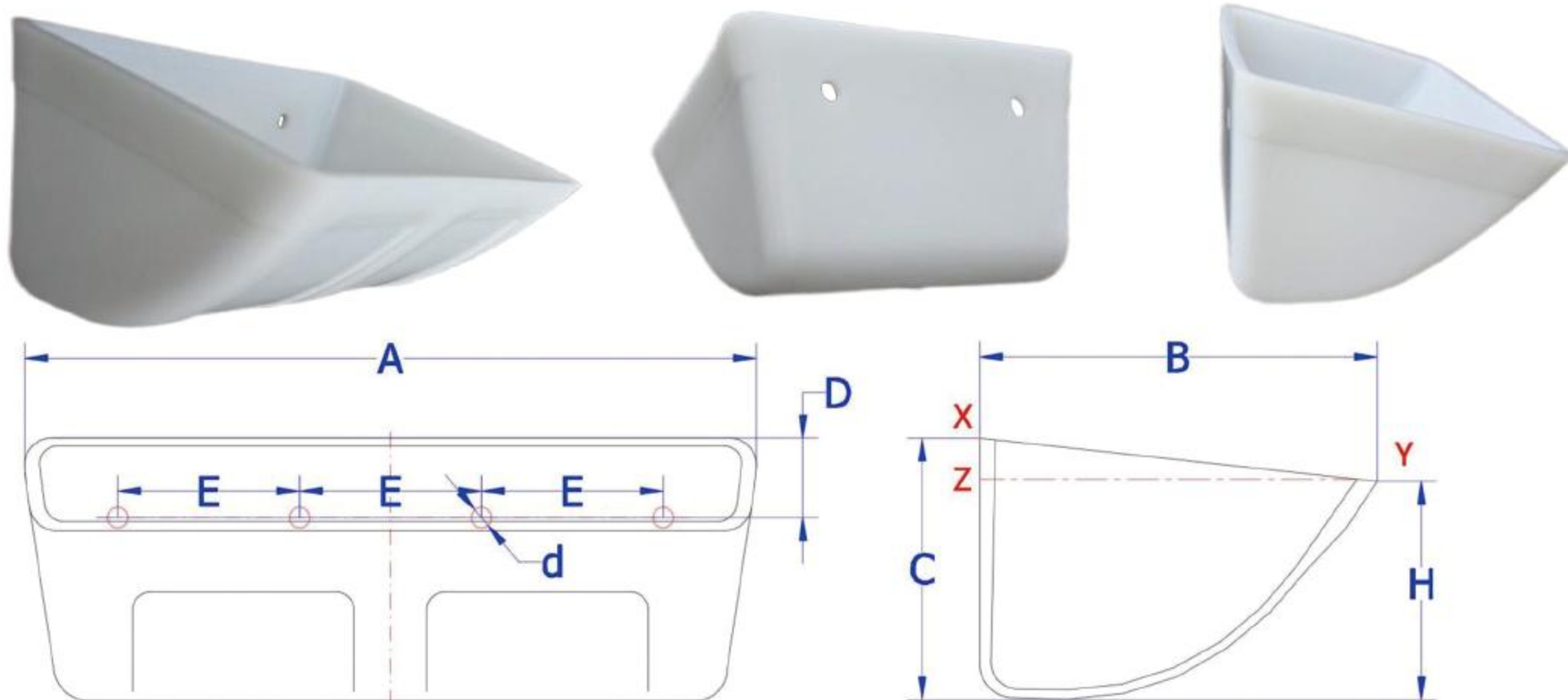

- Applicable to a broader range of speed and material;
- Recommended minimum bucket distance is size "B" + 25 mm size, can be adjusted according to request of lifting capacity.
- It is recommended that the linear speed of the elevator be less than 3.0 m/s. Can be adjusted according to the size of the head wheel diameter of the elevator, as well as the change of grain Angle.
- Recommended "(Z-Y) + 10%" volume as available capacity of the engineering design.

The data in the table is based on HDPE material, and the corresponding data of nylon material is +1.5% on this basis)

Model	Length A (mm)	Proj. B (mm)	Depth C (mm)	Height H (mm)	Distance D (mm)	Center E (mm)	Holes num	Hole dia d (mm)	Capacity (Z-Y)+10% (L)	Capacity (Z-Y) (L)
M1312	135	120	85	60	25	70	2	7	0.55	0.50
M1814	185	153	113	78	30	100	2	9	1.54	1.40
M2316	248	173	130	101	35	120	2	9	2.53	2.30
M2816	286	175	130	94	35	80	3	9	2.97	2.70
M3017	300	183	115	84	35	90	3	9	3.40	3.10
M3317	322	175	115	96	35	80	4	9	3.69	3.35
M3321	340	230	170	103	45	120	3	11	5.94	5.40
M3721	382	230	170	123	45	90	4	11	6.82	6.20
M4221	430	230	170	118	45	90	5	11	7.82	7.11
M5121	518	230	172	118	45	100	5	11	9.46	8.60
Remark	Fitting holes and hole diameter canbe customized									

- The data in the table is based on HDPE material, and the corresponding data of nylon material is +1.5% on this basis)

Model	Length A (mm)	Proj B (mm)	Depth C (mm)	Height H (mm)	Distance D (mm)	Center E (mm)	Holes num	Hole dia d (mm)	Capacity (L)
DM1310	141	113	124	97	37	80	2	7	0.95
DM1413	143	145	164	111	52	93	2	9	1.60
DM1715	175	156	170	120	52	113	2	9	2.30
DM2017	207	177	187	159	60	139	2	9	3.40
DX2118	218	191	210	146	60	140	2	9	4.20
DM2313	234	135	136	127	44	125	2	7	2.00
DM2419	244	190	188	159	65	90	3	9	4.90
DM2917	293	173	190	149	60	110	3	9	5.30
DX2918	290	174	195	120	70	100	3	9	5.40
DM2921	294	210	194	158	55	113	3	9	6.00
DX3321	340	219	215	176	65	85	4	9	7.60
DX3921	397	215	215	154	65	100	4	11	9.30
DX4721	485	217	215	130	75	95	5	11	11.50
Remark	DX series fitting holes and hole diameter can be customized, DM series can't be.								

DH Series Drying Bucket (HDPE & NYLON)

Used for drying elevator in grain processing industry.

- Suitable for high-speed centrifugal discharge.
- A, B, C size show on the followed table are Nylon bucket size, HDPE bucket size will reduce about -2%.
- Recommend using“(Z-Y)”+10% as usable capacity for engineering design.

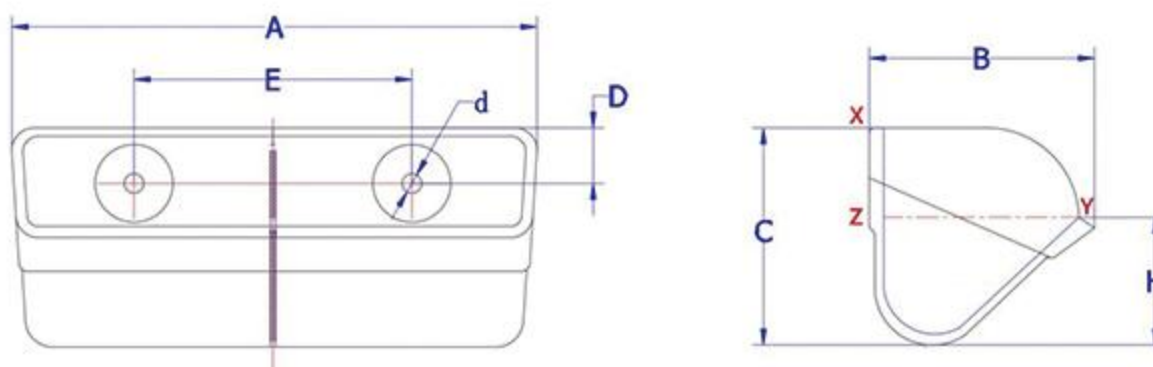

The data in the table is based on HDPE material, and the corresponding data of nylon material is +1.5% on this basis)

Model	Length A (mm)	Proj. B (mm)	Depth C (mm)	Height H (mm)	Distance D (mm)	Center E (mm)	Holes num	Hole dia d (mm)	Capacity (Z-Y)+10% (L)	Capacity (Z-Y) (L)
DH1808	186	80	78	45	20	100	2	7	0.37	0.34
DH1812	190	130	97	62	32	120	2	9	0.96	0.87
DH1909	198	95	89	55	20	100	2	7	0.63	0.57
DH2010	200	98	100	70	20	120	2	7	0.66	0.60
DH2512	250	120	110	61	30	141	2	9	1.10	1.00
DH2917	290	183	119	85	30	90	3	9	3.12	2.84
Remark	Fitting holes and hole diameter canbe customized									

E Series Shallow Type Bucket (HDPE & NYLON)

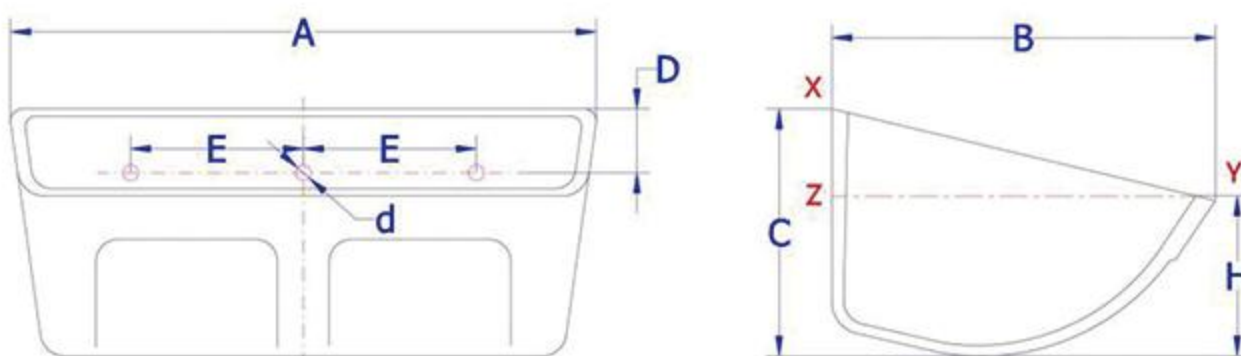

- Suitable for high speed centrifugal discharge and lifting of light bulk material;
- Suggest hoist speed 3.5 meters/seconds or less, can improve the nose wheel diameter size, due to throw food Angle change and adjusted;
- Recommended “(Z-Y)+5%” volume as available capacity of the engineering design.

The data in the table is based on HDPE material, and the corresponding data of nylon material is +1.5% on this basis)

Model	Length A (mm)	Proj. B (mm)	Depth C (mm)	Height H (mm)	Distance D (mm)	Center E (mm)	Holes num	Hole dia d (mm)	Capacity (Z-Y)+5% (L)	Capacity (Z-Y) (L)
E30	187	145	92	62	30	100	2	9	1.04	0.99
E36	236	147	94	65	30	120	2	9	1.38	1.31
E40	287	179	111	70	35	90	3	9	2.36	2.25
E50	312	189	123	81	40	80	4	9	3.31	3.15
E60	339	222	142	92	40	85	4	9	4.52	4.30
Remark	Fitting holes and hole diameter canbe customized									

DL Series Z Type Elevator Bucket (HDPE & NYLON)

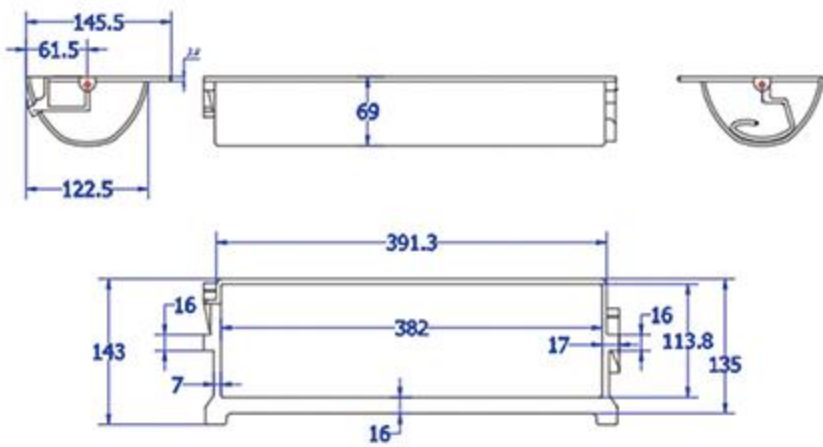

DL 4013

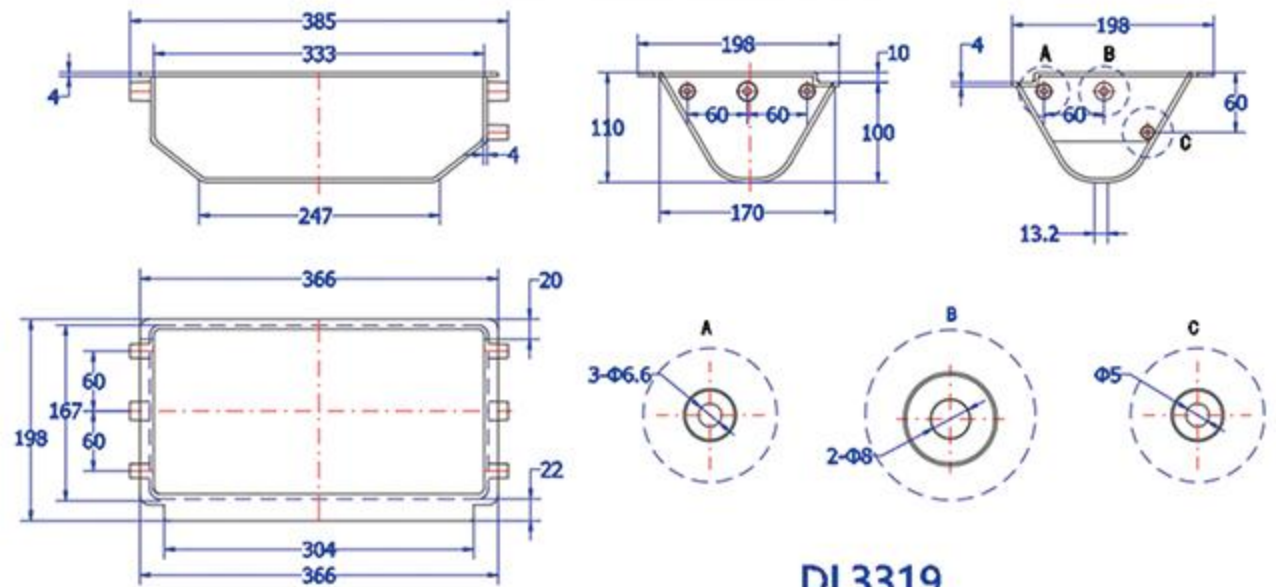

DL3319

● It is suitable for the chain conveyor which have vertical and horizontal mixing conveying and more application in seed and food processing industry.

The data in the table is based on HDPE material, and the corresponding data of nylon material is +1.5% on this basis)

Model	Length A (mm)	Proj. B (mm)	Depth C (mm)	Capacity (×-Y) (L)
DL3319	347	198	110	3.60
DL4013	390	135	69	2.00
DL4123	410	233	117	5.50
Remark	Fitting holes and hole diameter canbe customized			

DL Chain (Used in Z type Elevator Bucket)

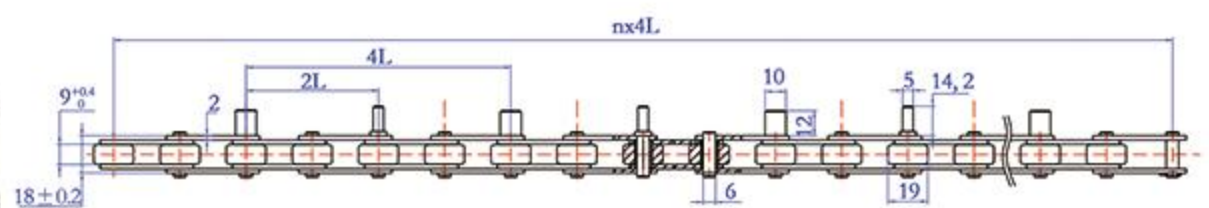
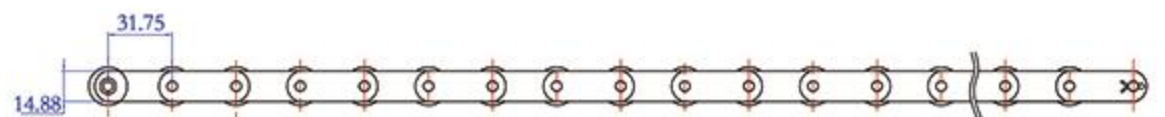

DL Sprocket (Used in Z type Elevator Bucket)

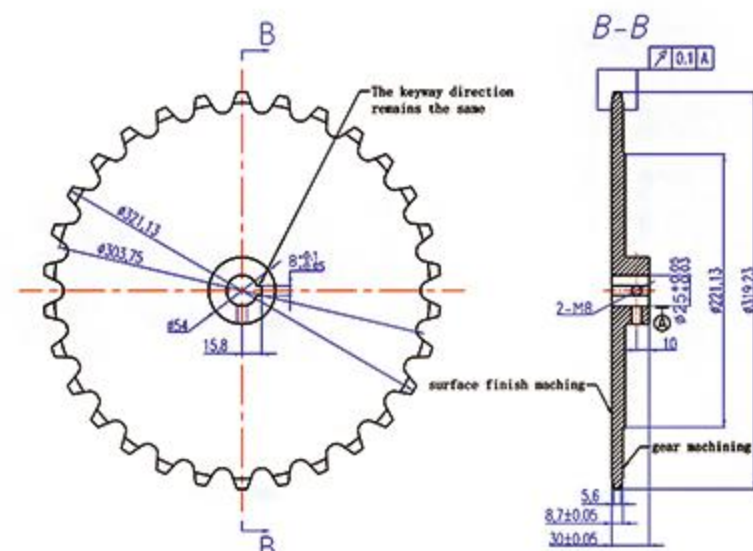

Whole stamping steel bucket

Our steel buckets use high quality steel and deep stretching manufacturing process. Whole stamping no seamless and welding, have more strength and abrasion resistance.

MATERIAL: carbon steel, stainless steel.

- Whole stamping steel bucket adopts deep drawing processing lead to higher overall strength.
- High temperature performance is outstanding, especially suitable for high temperature environment.
- High surface hardness, suitable for conveying the very sharp material and large bulk material.
- Can mixed use with plastic bucket, attention to balance problem
- It is suitable for conveying bulk materials.

DS Series Deep Type Steel Bucket

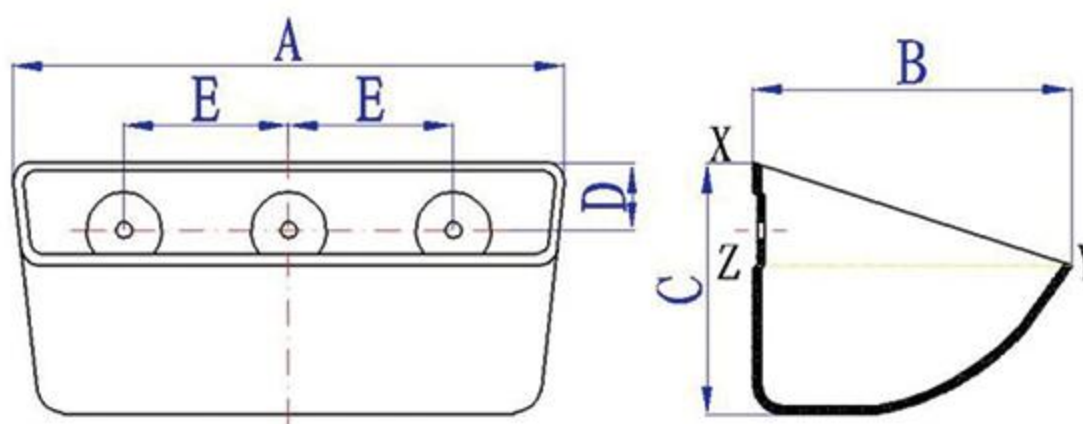

- Suitable for mixed discharge or gravity discharge.
- Recommended minimum bucket distance is "B" + 25 mm size, can be adjusted according to request of lifting capacity.
- Suggest hoist speed 2.5 meters/seconds or less, can adjust base on the pulley diameter size or throw food Angle.
- Recommended "(Z-Y)+10%" volume as available capacity of the engineering design.

[illegible]

Model	Length A (mm)	Proj. B (mm)	Depth C (mm)	Center E (mm)	Holes num	Hole dia d (mm)	Thickness (mm)	Capacity (×-Y) (L)
DS2314-1.5	233	142	115	120	2	9	1.5	1.98
DS2316-1.5	236	162	125	70	3	9	1.5	1.52
DS2316-2.0	238	166	130	70	3	9	2.0	2.2
DS2417-2.0	240	170	125	120	2	9	2.0	2.32
DS2614-2.0	265	140	110	150	2	9	2.0	2.32
DS2616-2.0	260	162	134	80	3	9	2.0	2.81
DS2813-1.5	288	130	112	100	3	9	1.5	2.44
DS2814-2.0	283	142	115	100	3	9	2.0	2.29
DS2816-2.0	283	168	130	100	3	9	2.0	3.17
DS2817-2.0	288	178	138	100	3	9	2.0	3.91
DS2818-2.0	290	183	142	100	3	9	2.0	3.87
DS2823-2.0	285	208	168	100	3	9	2.0	5.47
DS2916-2.0	290	168	130	100	3	9	2.0	3.28
DS3114-2.0	305	143	128	100	3	9	2.0	2.59
DS3118-2.0	315	190	155	75	4	9	2.0	4.18
DS3121-2.0	315	220	160	100	3	11	2.0	5.8
DS3216-2.0	320	160	135	110	3	11	2.0	3.65
DS3225-2.0	318	245	160	100	3	11	2.0	/
DS3518-2.0	358	191	145	120	3	11	2.0	4.16
DS3621-2.5	358	220	160	90	4	11	2.5	7.14
DS3823-2.0	385	230	163	90	4	9	2	5.93
DS4118-2.5	415	190	160	95	4	11	2.5	6.45
DS4121-2.5	415	220	175	95	4	11	2.5	7.86
DS4621-2.5	460	220	160	90	5	11	2.5	8.84
DS4723-2.5	475	233	160	95	5	11	2.5	7.82
DS5121-2.5	518	220	160	100	5	11	2.5	10.18
DS5121-3.0	518	220	160	100	5	11	3.0	10.18
DS5626-2.5	560	260	175	105	5	11	2.5	11.9
Remark	Fitting holes and hole diameter canbe customized							

DQ Series Shallow Type Steel Bucket

- Suitable for high-speed centrifugal discharge.
- Recommended minimum bucket distance is "B" + 25 mm size, can be adjusted according to request of lifting capacity.
- Suggest hoist speed 3.5 meters/seconds or less, can adjust base on the pulley diameter size or throw food Angle.
- Recommended "(Z-Y)+5%" volume as available capacity of the engineering design.

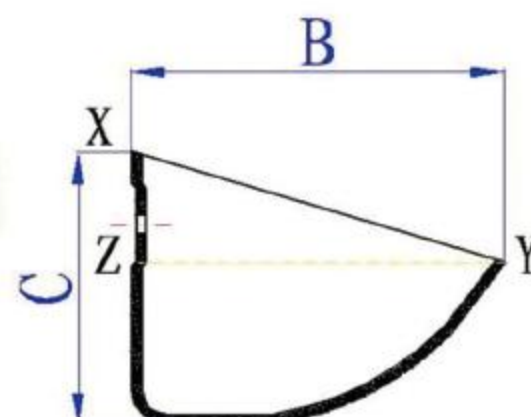
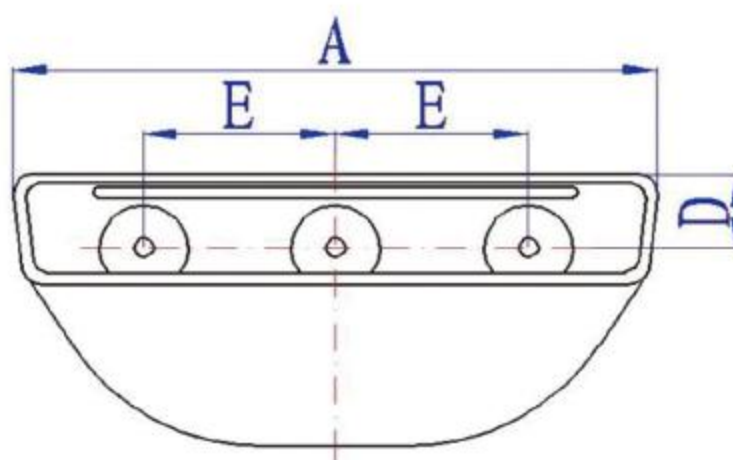

[illegible]

PVC Elevator Belt



PVC Green Elevator Belt



PVG White Environmental Belt



PU Environmental Belt



PVC Black Elevator Belt

- PVC elevator belt has solid woven carcass as the core, put it into impregnated PVC paste resin to plastify under high temperature. It is fire resistance and anti-static solid woven elevator belt.
- The carcass of PVC belt is solid woven type, which inter weaved by polyester and cotton. Compared to the rubber elevator belt, it is uniformly stressed to ensure the strong elevating capability. No delaminating occurs under normal operating conditions. Flexibility allows for smoother running along the elevator pulley, keep a good running trail and not easy to off track.
- Tight woven carcass after dipping in PVC paste resin have the excellent ability of elevating, at the same time, have higher tear resistant performance, can also prevent the bolts pull-through easily, make reliable and secure fixing of the bucket to the belt.
- PVC belt has better characteristics of resistance to oil and chemical solvent, wear resistance and anti-corrosion.
- PVG belt and PU belt is our company combined with the latest trend in industry to develop, they have obtained many patents, reached the leading environmental protection and food grade requirements in domestic.
- Characteristics of fire resistance and anti-static make this belt more safer more effective for using in grain handling applications.

Overall Specifications

Type	Colour	Tensile Strength (N/mm)	Ambient temperature (°C)	Elongation @ 10% tensile Strength (%)	Environmental protection	Flame resistance	Conductivity
PVC480	green or Black	≥480	-15 ~ +85	0.7	operation	operation	✓
PVC680		≥680		0.8	operation	operation	✓
PVC880		≥880		0.9	operation	operation	✓
PVC1080		≥1080		0.9	operation	operation	✓
PVG480	white	≥480	-15 ~ +85	0.7	✓	operation	operation
PVG680		≥680		0.8	✓	operation	operation
PVG880		≥880		0.9	✓	operation	operation

Performance of PVC Cover

Items	Unit	Index Value
Tensile Strength	Mpa	≥15
Elongation @ Break	%	≥300
Abrasion Loss	mm ³	≤100
Conductivity	MΩ	≤300
Winding property	200,000 times	without crack
Hardness	Shore A	70
Friction coefficient (with steel)	/	0.68

EP Rubber Elevator Belt

Supply characteristics

- * length and width can be customized .
- * Drill hole service can be provided to make install and usage easy.



- EP rubber elevator belt, The frame material is synthetic fiber impregnated canva, Low shrinkage polyester is used in warp and weft direction , And add a layer of wear-resistant canvas on the contact surface between the lifting belt and the head wheel. It is a high performance belt suitable for food and food processing industry.
- Be custom length and width according to customer requirements; Provide winnowing service for installation and use.
- Mainly apply to normal temperature, no wet and corrosion environment. Usually for small bulk granular materials of non-oleaginous or non-biological additives.
- Elevator belt width $\geq 500\text{mm}$ and the height ≥ 35 meters. Enhanced round edge elevator belt can be customized according to the intensity request.
- According to the work condition, heat-resistant, anti-corrosion and anti-static elevator belt can be customized.
- In order to improve the transmission efficiency, reduce abnormal wear of the belt, we recommended to use pulley with rubber cover.

Overall Specifications

Type	Carcass structure	Tensile Strength (N/mm)	Ambient temperature ($^{\circ}\text{C}$)	Elongation @ 10% tensile strength (%)	Temperature resistance	Cold resistance	Oil resistance	Inflaming retarding
600YP	3EP+1CC	600	-20 ~ +70	≤ 1.6	operation	operation	operation	operation
800YP	4EP+1CC	800						
1000YP	5EP+1CC	1000						

Cover Rubber Properties

Items	Index Value	Items	Index Value
Carcass Ply to Carcass Ply	4.5(Mp)	Abrasion loss	≤ 150 (mm ³)
Cover to Carcass Ply	3.5 (Mp)	Hardness	60-65(Shore A)
Tensile Strength	≥ 18 (Mp)	Elongation @ Break	≥ 420 (%)
Friction coefficient	0.75	Acid Properties	20 (%)
Friction coefficient	> 1	Alkali Properties	5.2 (%)

Fang Bolt

Bolt Set Options



Hexagon Nut



Nyloc Nut



Domed Washer



Flat Washer

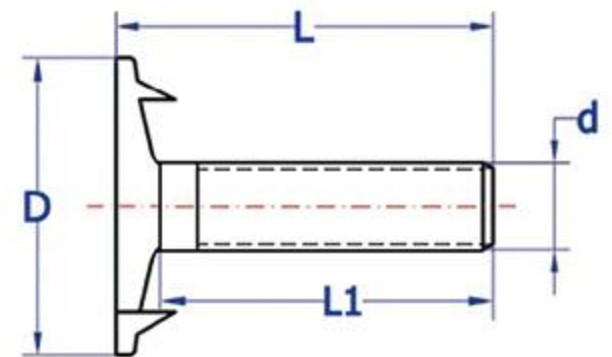

Spring Washer

**P type****Y type****S type****W type****WS type**

- Tolerance quality is 6g, mechanical properties grade is greater than 6.8. Surface treatment is galvanized. not include stainless steel.
- Applied to lift heavy capacity materials and can be used in highline speed. It is suitable for plastic bucket and steel bucket. Especially for install big capacity bucket or big convexity bucket. It also can borne heavy impact load during the operation of the equipment..



Common specifications (Material: Carbon Steel-Zinc Plated, Stainless Steel)

Size	mm d	D mm	L mm	L1 mm
M6×25	M6	22	25	20
M6×30	M6	22	30	25
M6×38	M6	22	38	32
M8×30	M8	27	30	22
M8×35	M8	27	35	28
M8×42	M8	27	42	35
M8×45	M8	27	45	38
M10×35	M10	32	35	25
M10×45	M10	32	45	35
M10×50	M10	32	50	40

Example bolt specification: M6×25P, M8×30S, M8×35Y, M10×45WS

Notes: Stainless steel bolts, D size will be slightly smaller than carbon steel

ORDINARY BOLT

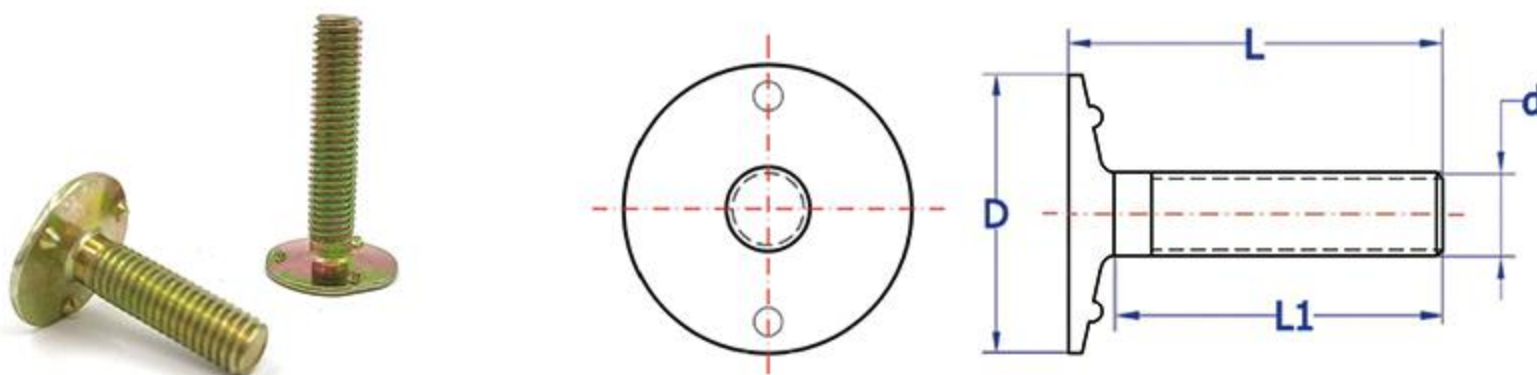

- Tolerance quality is 6g, mechanical properties grade is greater than 4.8. Surface treatment is oxidation or galvanized.
- Applied to lift low density materials and can be used in low speed. It is suitable for plastic bucket, is a economical bolt.

Common specifications (Material: Carbon Steel -Zinc Plated)

Size	Ø mm	D mm	L mm	L1 mm
M6×22	M6	18	22	18
M6×30	M6	18	30	25
M8×30	M8	23	30	24
M8×38	M8	23	38	30
M10×35	M10	30	35	25
M10×40	M10	30	40	30

Euro Bolt

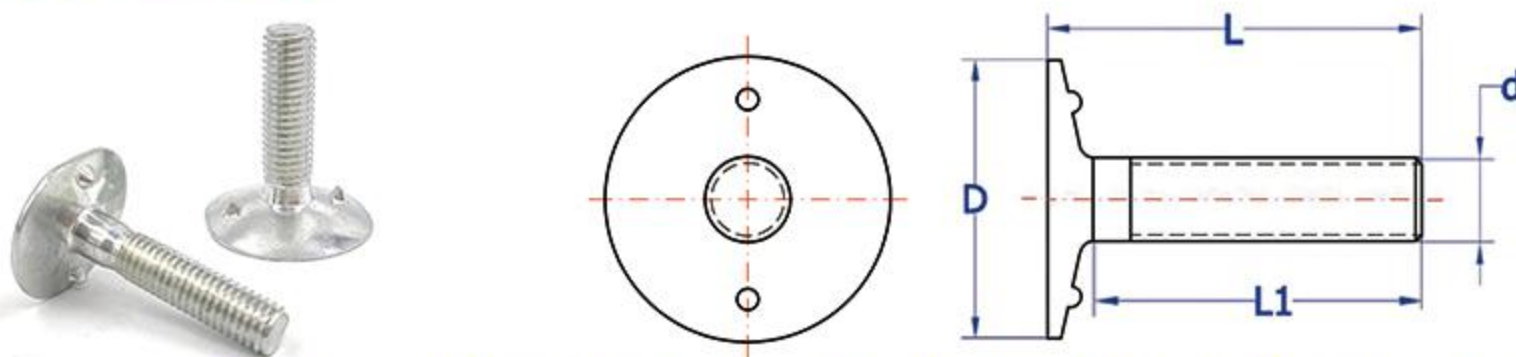

Common specifications (Material: Carbon Steel -Zinc Plated, Stainless Steel)

Size	d		L		L1	D
1/4"×1"	1/4"	6.35mm	1"	25.4mm	20	25mm
1/4"×1 1/4"	1/4"	6.35mm	1 1/4"	31.8mm	27	25mm
1/4"×1 1/2"	1/4"	6.35mm	1 1/2"	38.1mm	33	25mm
5/16"×1 1/4"	5/16"	7.94mm	1 1/4"	31.8mm	24	30mm
5/16"×1 3/8"	5/16"	7.94mm	1 3/8"	34.9mm	27	30mm
5/16"×1 1/2"	5/16"	7.94mm	1 1/2"	38.1mm	30	30mm
3/8"×1 1/4"	3/8"	9.53mm	1 1/4"	31.8mm	22	35mm
3/8"×1 3/8"	3/8"	9.53mm	1 3/8"	34.9mm	25	35mm
3/8"×1 1/2"	3/8"	9.53mm	1 1/2"	38.1mm	28	35mm
3/8"×1 3/4"	3/8"	9.53mm	1 3/4"	44.5mm	35	35mm
1/2"×1 3/8"	1/2"	12.7mm	1 1/2"	38.1mm	23	38mm
1/2"×1 3/4"	1/2"	12.7mm	1 3/4"	44.5mm	30	38mm
1/2"×2"	1/2"	12.7mm	2"	50.8mm	35	38mm

Belt Clamp Fastener

**S1****S2****S4****S5**

- Proper belt clamp will directly influence the running reliability, safety and life span of the elevator belt. It's the safest, the most economical, and the most widely design up to now. Our belt fasteners are widely used by many conveyor equipment manufactures and have unanimous recognition and praise of experts.
- S1 use integral stamping forming, The material is carbon steel galvanized.
- S2 integral stamping then welding forming, The material is carbon steel galvanized.
- S4 and S5 are precision cast from three parts, Materials are cast steel galvanized and stainless steel two kinds.
- It comes with 8.8 grade high strength bolts and thickened self-locking nuts, Can effectively prevent the operation of the fixture loose.
- The combined structure is easy to interchange and install. High assembly precision. Surface galvanizing. Good anti-rust effect.

S1	S2	S4	S5
Strength $\leq 800\text{KN/m}$	Strength $\leq 1000\text{KN/m}$	Strength $\leq 1200\text{KN/m}$	Strength $\leq 1600\text{KN/m}$
Collet width $W=45\text{mm}$	Collet width $W=45\text{mm}$	Collet width $W=48\text{mm}$	Collet width $W=48\text{mm}$
Collet height $H=55\text{mm}$	Collet height $H=56\text{mm}$	Collet height $H=72\text{mm}$	Collet height $H=75\text{mm}$
Bolt length $L=55\text{mm}$	Bolt length $L=125\text{mm}$	bolt length $L=130\text{mm}$	Bolt length $L=140\text{mm}$
Tread specification: S1&S2-M10;S4-M12;S5-M16;bolt strength class 8.8			

Key points of install belt clamps

- Choose different fastener type and quantity according to your belt strength and width.
- Elevator belt round length + Fastener connect belt length = Total belt length.
- Fastener connect belt length: S1+180mm, S2+190mm, S4+220mm, S5+230mm.
- Set aside some distance (S1&S2--60mm, S4&S5--80mm) from the top of the connect belt, make a center line for the mounting hole. Make sure the center line is perpendicular to elevator belt radial direction or its two edges. It helps make sure the belt won't go deviated when the elevator is running.

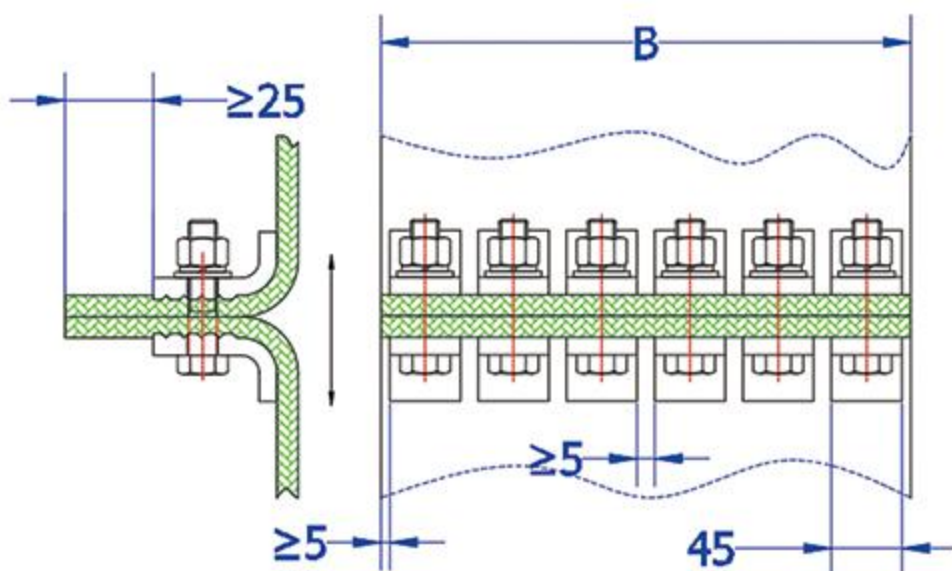
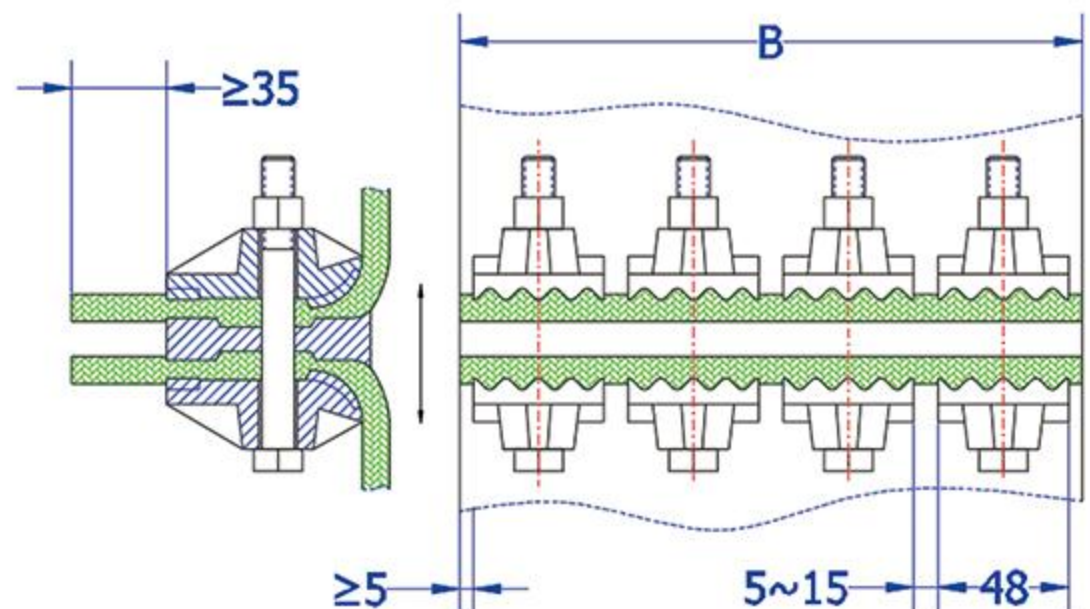
**S1、S2****S4、S5**

Pulley Lagging

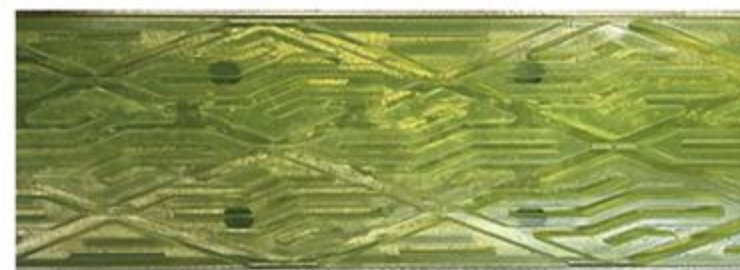

Rubber type

Sectional view

Polyurethane(PU) type

- Reduce the replacement frequency, fast repair speed, do not need to remove the head pulley, pull out the old insert board, change the new insert board, reduce the time of the maintenance and use costs.
- Use high elasticity, high wear-resisting rubber raw materials, have a higher wear resistance.
- Wear-resisting layer adopts the special groove structure, increased coefficient of elevator belt and the head pulley, higher attached strength prevent the pulley slip.
- Significantly reduce the cost of maintenance and replacement frequency, reduce the labor intensity.

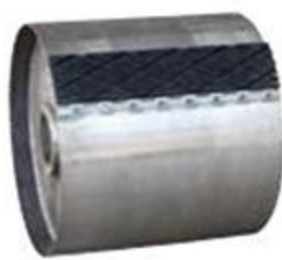
Item	Length (mm)	Width (mm)	Thickness (mm)	Rubber cover Shore	Wear Resistance $\leq \text{mm}^3$
Rubber type	1830	135	15	70±5	100
PU Type	1830	135	/	/	/

Install method: Welding Installation, Bolt Installation

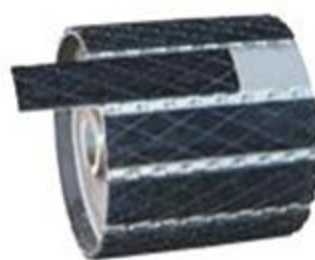
Step 1

Step 2

Step 3

Step 4

Step 5

Step 6

Conveyor Chains

Bush roller chain (used in U type scraper conveyor)

Model: GLR For TGSU arc scraper conveyor, install U type scrapper

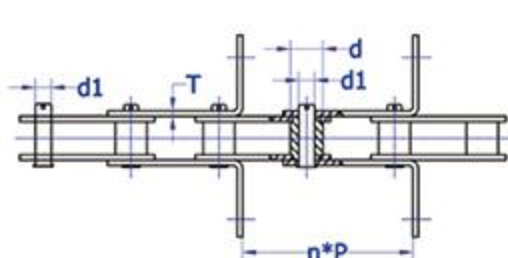
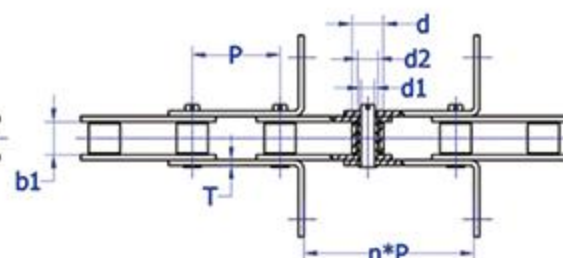
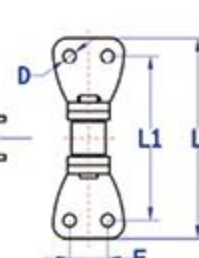
Type A : Bush fixed

Type B : Bush rotatable

Common specifications (Material: Carbon Steel, Stainless Steel)

Type	Pitch P mm	between inner plates b1 mm	Bush Diameter D mm	Pin Diameter d1 mm	Bush Diameter d2 mm	Plate Width H mm	Plate Thickness T mm	Flight Attachment (mm)				Rated Strength KN
								Width L mm	Distance L1 mm	Distance Emm	diameter D mm	
GLR68(5)	68	25.3	22.23	11.1	16.23	29	5	/	102	32	4-Φ9	140
GLR60(6)D	60	26.0	22.23	12.7	/	30	6	130	100	32	4-Φ9	140
GLR66.5(6)D	66.5	26.5	22.23	12.7	16.23	30	6	130	102	32	4-Φ9	140
GLR80(6)D	80	32.0	28.00	18.0	/	42	6	160	120	32	4-Φ9	140
GLR100(6)D	100	38.5	36.00	15.7	21.6	40	6	130	102	32	4-Φ9	180

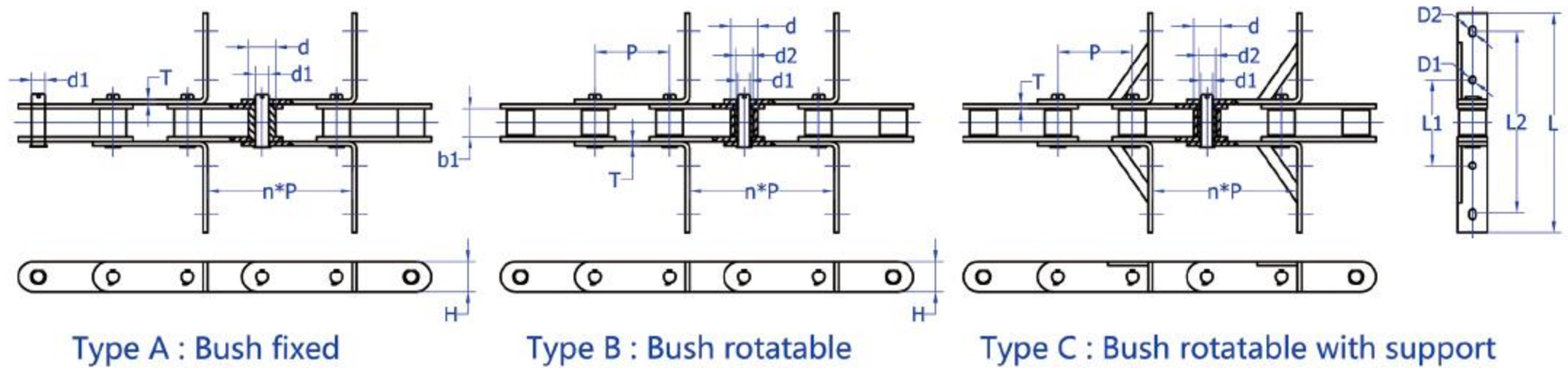
Bush roller chain (used in horizontal scraper conveyor)



- Chains adopt high quality medium-carbon alloy steel, chain plate material is 40Mn, pin and roller material is 40Cr.
- High quality material and good heat treatment guarantee excellent anti-shearing force and tensile strength during working and have good looking.
- Model: GLF For TGSS flat scraper conveyor, install flat scraper

Common specifications (Material: Carbon Steel, Stainless Steel)

Type	Pitch P mm	between inner plates b1mm	Bush Diameter d mm	Pin Diameter d1 mm	Bush Diameter d2 mm	Plate Width H mm	Plate Thickness T mm	Flight Attachment (mm)					Rated Strength KN
								Width L	Distance L1	Distance L2	diameter D1	diameter D2	
GLF66.5(6)D	66.5	26.5	22.23	11.1 (Three piece set)	16.23	30	5/6	160	102	/	2-Φ9	/	140
				12.7 (Two piece set)	/			230	95	195	2-Φ9	2-Φ9×14	
								270	102	228			
GLF66.675(6)D	66.675	26.5	22.23	11.1 (Three piece set)	16.23	30	5/6	182	90	150	2-Φ9	2-Φ9×14	140
				12.7 (Two piece set)	/			215	95	195			
								295	95	195			
GLF100(6)	100	38.5	36.0	15.7	21.6	40	6	170	115	/	2-Φ9	/	180
								225	95	195	2-Φ9	2-Φ9×14	
								294	115	245			
								370	155	255			
GLF125(6)D	125	32.5	25.0	18.0	/	50	6	300	115	245	2-Φ9	2-Φ9×14	200
								370	130	330			
GLF160(8)D×385	160	36.5	36.0	17.8	24.50	50	8	385	130	330	2-Φ11	2-Φ11×15	220
GLF200(8)D×467	200	42.5	40.0	20.0	30.00	60	8	467	160	420	2-Φ13	2-Φ13×17	250
81×	66.27	27	23	11.1	16.23	28.6	4	Welding attached plate, length and hole size customized Wood transport chain according to customer requirements				/	107
81×H						31.4	6/8					/	152
81×HH							8					/	191

NOTE: Other specifications which are not listed above can be made to customs' specifications.

Ring Chain

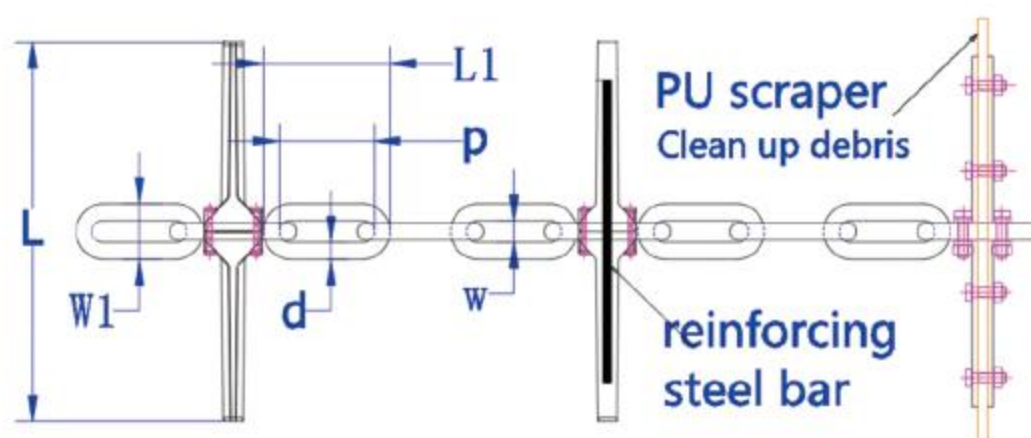

DRAG CONVEYOR Type	Ring Chain Type	Pitch P(mm)	Diameter d(mm)	length L1 (mm)	Width W1 (mm)	Flight Type	Wing Width L(mm)	Flight Width H(mm)
GSS16	D10-55-13	55	10	74	13	HF16	148	43.5
GSS20	D10-55-13	55	10	74	13	HF20	188	43.5
GSS25	D10-55-13	55	10	74	13	HF25	225	43.5
GSS32	D14-70-18	70	14	95	18	HF32	300	54.5
GSS40	D14-70-18	70	14	95	18	HF40	382	54.5

Note: The installation spacing of the nylon scraper is 4 links. We suggest every 4-6pcs of nylon scraper add one PU scraper to better remove the material residue in the scraper slot.

Ring Chain Flight attached

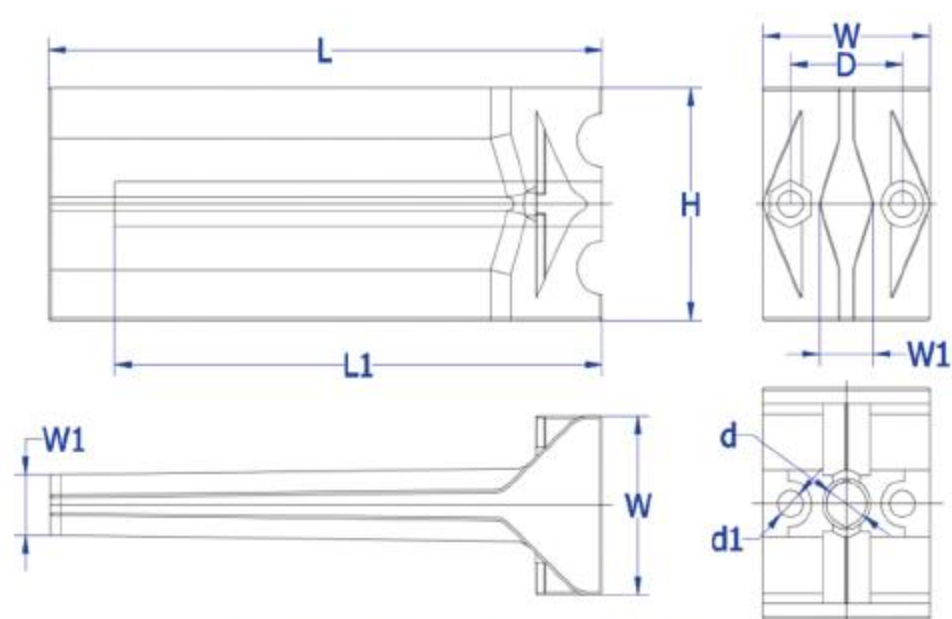

Flight of Ring Chain (Nylon)

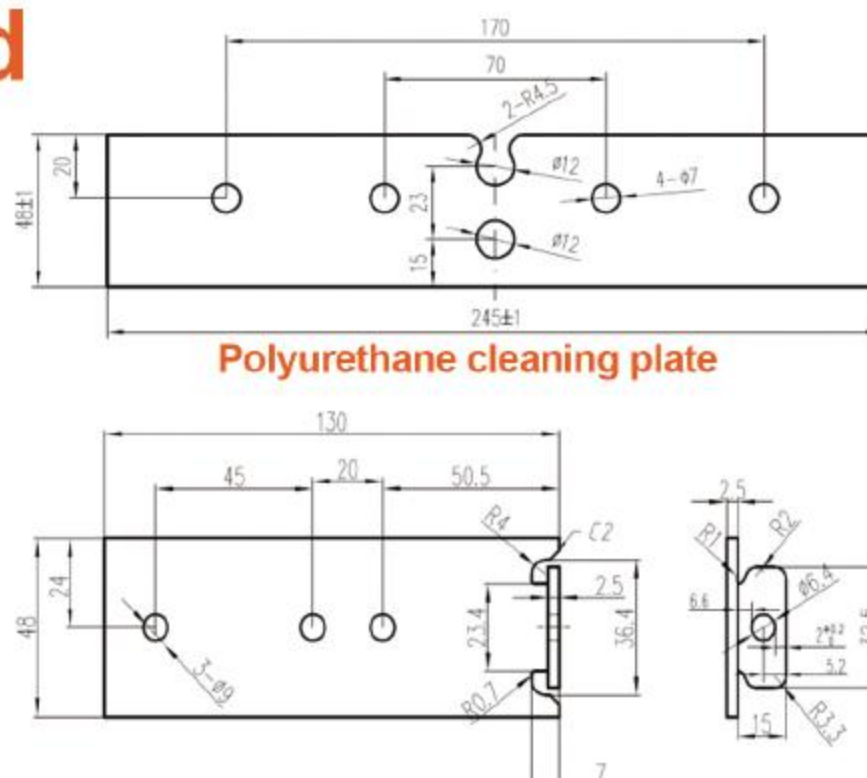

Mounting splint of Polyurethane cleaning plate

Item	Units	Quantity	Ring Chain Drag Conveyor Model				
			TGSH16	TGSH20	TGSH25	TGSH32	TGSH40
Ring Chain	Meter	-	10-55×13	10-55×13	10-55×13	14-70×18	14-70×18
Sprocket of Ring Chain	Piece	-	Z5×50×14/10-55×13			Z6×60×18/14-70×17.5	
Flight of Ring Chain	Piece	2	HF16	HF20	HF25	HF32	HF40
Inner Hexagon Screw with Nut	Set	2	M5×30	M5×30	M5×30	M5×35	M6×35
Reinforcing Steel Bar	Piece	1	8×115	8×160	8×175	8×260	8×310
Polyurethane cleaning plate	Piece	1	155×48×6	195×48×6	249×48×6	310×60×6	390×60×6
Mounting splint	Piece	4	61×35×2.5	81×35×2.5	95×35×2.5	130×48×2.5	166×48×2.5
Hex head bolt 1 with Nut	Set	2	M5×30			M6×35	
Hex head bolt 2 with Nut	Set	4	M6×30			M8×35	

Offset Sidebar Chain

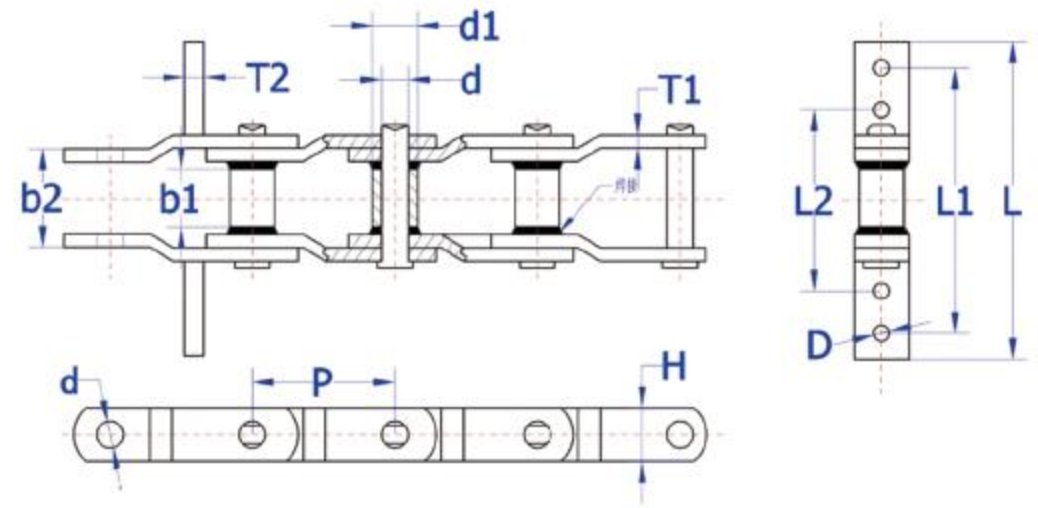

Type	Pitch P mm	Bush Diameter d_1	Pin Diameter d	Plate Width H	Width between plates at inner ends b_1	Width between plates at outer ends b_2	Plate Thickness T_1	Rated Strength KN	Wing Plate Thickness T_2	Wing Width L mm
WH78	66.27	22.23	12.7	28.4	28.4	51	6.4	93.4	Welding attached plate, length and hole size customized	
WH82	78.1	27	14.29	32	44	57	6.4	132		
WH124	101.6	31.75	19.1	38.1	41.2	74	9.5	300		
WH132	153.67	44.45	25.25	50.8	77.1	111.76	12.7	378		
WH150	153.67	44.45	25.4	63.5	77.1	111.76	12.7	398		
WH155	153.67	44.45	28.42	63.5	73.6	111.25	14.27	411		
WH157	153.67	44.45	28.42	63.5	76.4	117.35	15.88	552		

Forged Chain

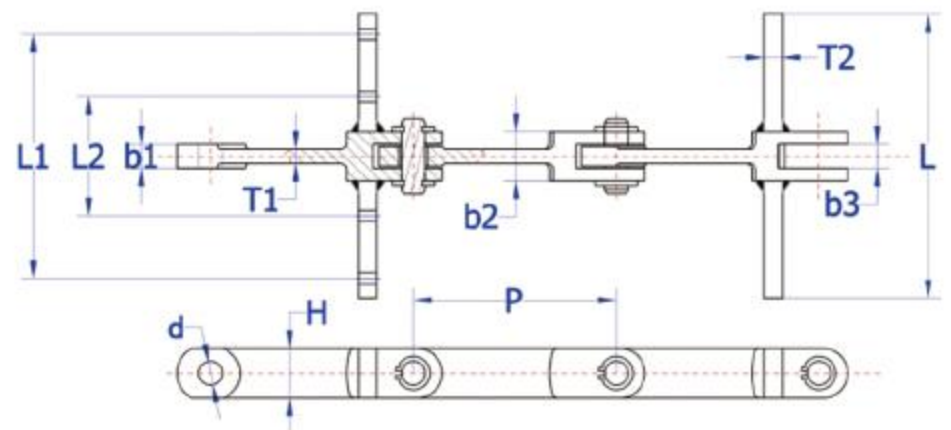

Pitch P (mm)	Pin Diameter d (mm)	Plate Width H (mm)	b_1 (mm)	b_2 (mm)	b_3 (mm)	T_1 (mm)	T_2 (mm)	Wing Width L (mm)	Rated Strength
100	14	30	15	33	16	13	6 (8)	Welding attached plate, length and hole size customized	140KN
125	16	36	15	36	16	10	6 (8)		150KN
142	25	50	19	42	20	12	8 (10)		270KN
142(H)	25	50	28	62	30	15	8 (10)		340KN
150	25	48	16	42	18	12	6 (8.10)		200KN
200	25	50	25.5	56	27	16	6 (8.10)		270KN

Drag Conveyor Flight (HDPE & Nylon)

BR series applicable to U type scraper conveyor (Self-cleaning scraper conveyor).

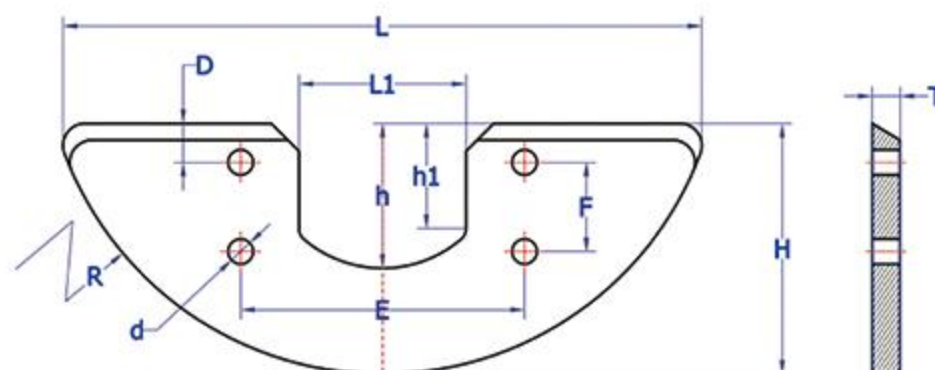

- It can effectively reduce the wear of the chain of the scraper conveyor.
- Low noise when chain is running.
- It can significantly reduce the damage of material conveying.

Type	L (mm)	L1 (mm)	T (mm)	H (mm)	h (mm)	h1 (mm)	R (mm)	E (mm)	F (mm)	D (mm)	d (mm)	Remark
BR100x74	180	55	10	74	43	43	100	102	32	12	9	length and hole size customized
BR100x90	195	60	10	90	57	45	100	102	32	14	9	
BR122x90	228	60	10	90	52	40	122	102	32	14	9	
BR125x100	238	60	10	100	63	52	125	102	32	11	9	
BR158x110	290	60	14	110	70	55	158	102	32	21	9	

BF type applicable to Flat scraper

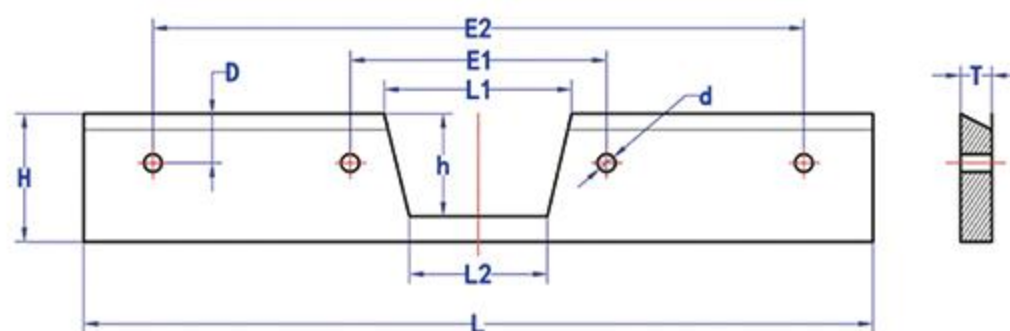

Type	L (mm)	L1 (mm)	L2 (mm)	T (mm)	H (mm)	H (mm)	E1 (mm)	E2 (mm)	D (mm)	d (mm)
BF145x45	145	75	60	14	45	33	102	/	19	9
BF184x45	184	75	60	14	45	33	102	/	19	9
BF194x49	194	72	60	14	49	36	90	150	17	9
BF240x49	240	74	72	14	49	36	95	195	17	9
BF284x45	284	75	60	14	45	33	102	228	19	9
BF305x45	305	75	60	14	45	33	102	228	19	9
BF305x50	305	90	60	14	50	35	115	245	15	9
BF305x55	305	70	65	14	55	37	95	195	22	9
BF380x60	380	70	65	15	60	45	155	255	25	9
BF380x90	380	92	70	15	90	70	155	255	44	9

Sprocket (For Round Link Chain & Forged Chain)



Round Link Chain



Forged Chain Sprocket



Forged Chain Tail Drum

Nylon Gear Wheel (for Chain Conveyor)

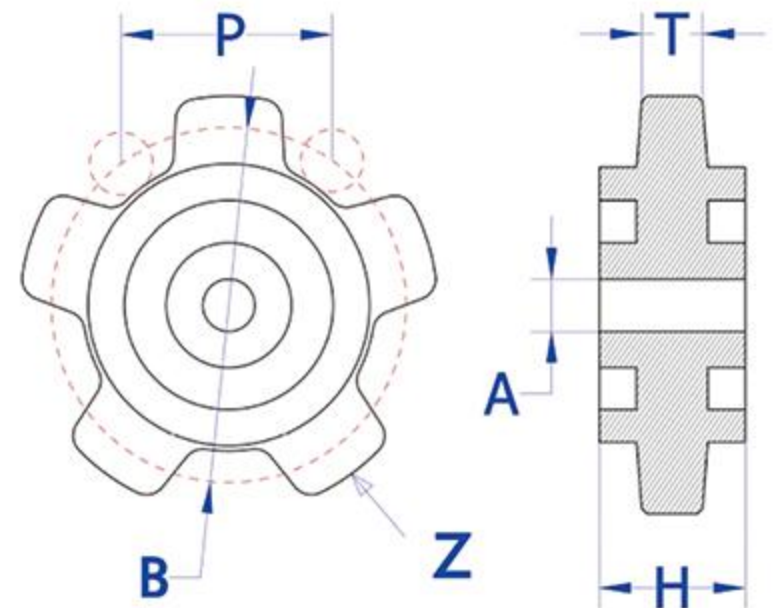

- Casting with reinforced nylon material, adopting advanced technology to eliminate potential damage.
- Better wear-resistance, higher intensity, anti-impact than ordinary nylon.
- Compared with traditional metal rails, nylon gear wheel not only support more steady but also used by leading the way of chains.
- It is used for supporting the chains in the conveyor under long distance and complex work environment.

Type	A mm	B mm	T mm	H mm	Pitch P mm	number of teeth Z
TG66.5x4	φ20	φ94.05	25	57	66.5	4
TG66.5x5	φ20-25	φ100	25	57	66.5	5
TG68x5	φ25	φ115.6	24	47	68	5
TG100x5A	φ25	φ170.0	34.2	70	100	5
TG100x5B	φ25	φ170.0	24.5	59	100	5

Sprocket (For Roller Chain & Welded Cranked Link Chain)

Common specifications: Carbon Steel, Stainless Steel



Integral Type

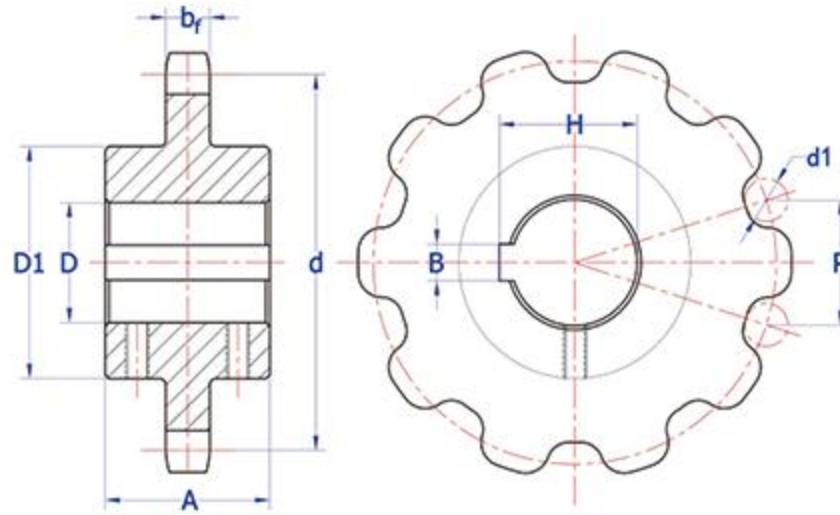

Detachable Type

Type	Pitch P mm	number of teeth Z	Bush Diameter d1 mm	Bore Diameter D mm	width of keyway B mm	Teeth Width b _f mm	lug boss Diameter D1 mm	lug boss Width A mm
LN66.5X7XΦ50X14/Φ22.23-26.5	66.5	7	22.23	50	14	22.8	100	100
LN66.5X8XΦ50X14/Φ22.23-26.5	66.5	8	22.23	50	14	22.8	100	100
LN66.5X9XΦ50X14/Φ22.23-26.5	66.5	9	22.23	50	14	22.8	100	100
LN66.5X10XΦ60X18/Φ22.23-26.5	66.5	10	22.23	60	18	22.8	110	100
LN68X8XΦ50X14/Φ22.23-26.5	68	8	22.23	50	14	22.8	100	100
LN68X9XΦ50X14/Φ22.23-26.5	68	9	22.23	50	14	22.8	100	100
LN68X12XΦ50X14/Φ22.23-26.5	68	12	22.23	50	14	22.8	100	100
LN76.2X12XΦ70X20/Φ30-30	76.2	12	30	70	20	26	120	100
LN100X7XΦ60X18/Φ36-38	100	7	36	60	18	33.2	100	100
LN100X8XΦ60X18/Φ36-38	100	8	36	60	18	33.2	100	100
LN100X9XΦ70X20/Φ36-38	100	9	36	70	20	33.2	120	100
LN100X10XΦ70X20/Φ36-38	100	10	36	70	20	33.2	120	100
LN100X11XΦ70X20/Φ36-38	100	11	36	70	20	33.2	120	100
LN100X12XΦ80X20/Φ36-38	100	12	36	80	20	33.2	130	100
LN100X14XΦ80X22/Φ36-38	100	14	36	80	22	33.2	130	100
LN100X15XΦ80X22/Φ36-38	100	15	36	80	22	33.2	130	100
LN125X8XΦ70X20/Φ25-32	125	8	25	70	20	27.8	120	100
LN125X10XΦ100X28/Φ40-50	125	10	40	100	28	44	160	130
LN160X6XΦ70X20/Φ36-36	160	6	36	70	20	31.4	120	100
LN200X8XΦ100X28/Φ40-42	200	8	40	100	28	36.8	160	130
LN200X7BXΦ75X22/Φ50-28	200	7	50	75	22	26	120	60

Engineering Plastic

Comparison of performance parameters

Commonly used wear-resistant material: UHMWPE, PU, MC Nylon, PTFE

Item	Unit	Standard Value			
		UHMWPE	PU	MC Nylon	PTFE
Density	g/cm ³	0.935	1.27	1.13-1.16	2.2~2.3
Water Absorption	%	< 0.01	/	1.5	< 0.01
Tensile strength @ break	MPa	40-45	≥40	≥70	≥ 14
Elongation @ Break	%	300-400	≥450	30-320	≥200
Izod Impact Strength	KJ/m ²	≥ 140	/	No Breaking	/
Hardness	shore	Shore D 70	Shore A 65-98	Rockwell RHM 103~118	Shore D 50~65
Abrasion loss	/	cm ³ /1.61km	Akron ≤0.06	/	/
Friction Coefficient	no lubrication	0.07-0.22	0.5-0.6	<0.45	<0.1
Surface Resistivity	Ω		7.8X10 ^{8~10}	/	/
Working Temperature	℃	-150 ~ 80	-40 ~ +80		-180 ~ +260
Linear Expansion Coefficient	10 ⁻⁵ /cm/℃	15 ~ 25	/	8.3	10.5
Thermal Deformation Temperature (0.46Mpa)	℃	85	/	150	121
Dielectric Strength	KV/mm	50	/	17.3-20.2	18.8-20.5

UHMWPE SHEET & ROD

- UHMW-PE is a thermoplastic engineering plastic which is polymerized by ethylene and butadiene monomer under the action of catalyst. The average molecular weight is more than 3.5 million -7.0 million.
- The product combines the superior performance of many plastics, have excellent wear resistance, impact resistance, chemical corrosion resistance, low temperature resistance, self-lubricity and other characteristics.
- Low friction coefficient, high wear resistance, high impact resistant.
- Excellent chemical stability. It can improve the corrosion resistance and anti-static performance by adjusting the formula.
- The temperature range: -150℃ to +80℃
- Low water absorption.

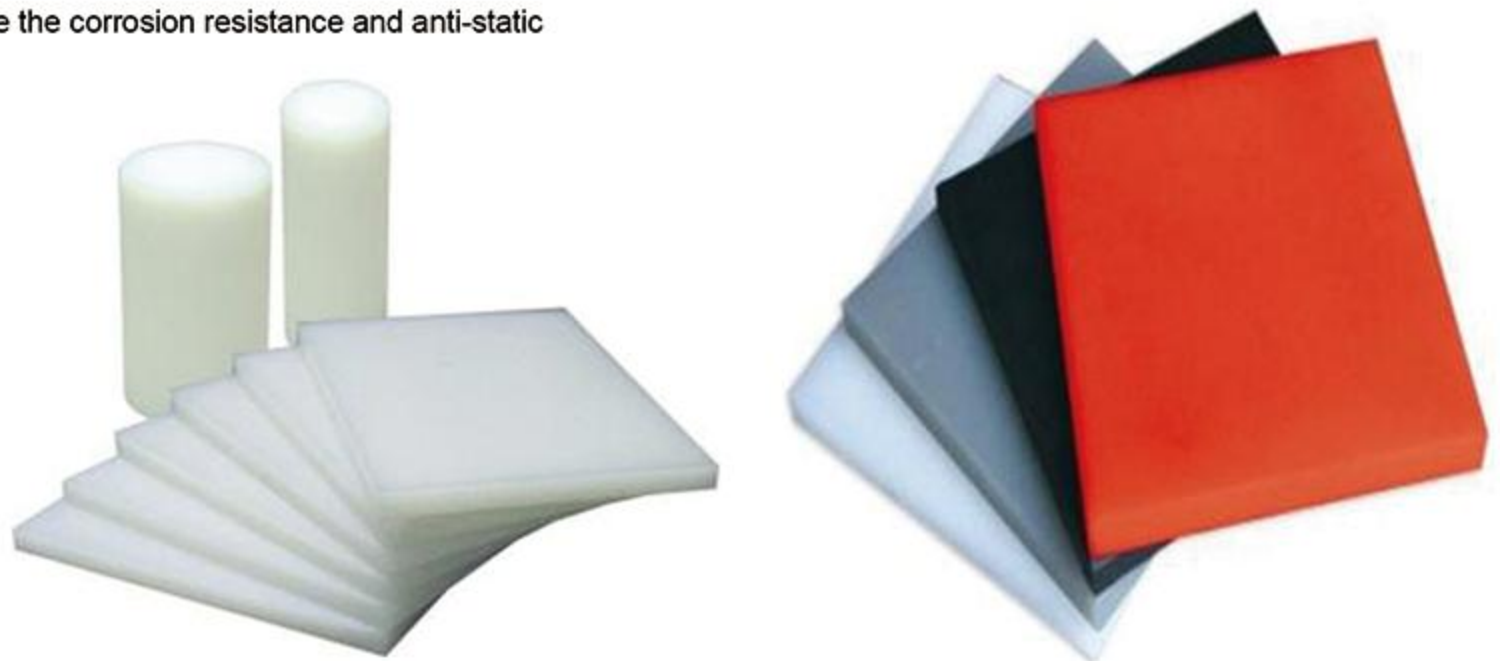

Item	Length (mm)	Width (mm)	Thickness (mm)	Outer Diameter (mm)
Sheet	3050	1250	6.5~30	/
Rod	≤1000	/	/	30-200
Stripe	≤50000	110	3	/

PU CASTING SHEET

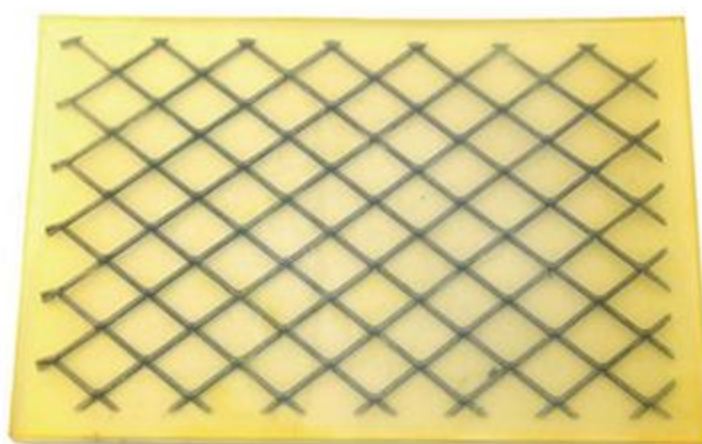

- PU material has good wear resistance, impact resistance and anti-static function. It has wide adjustable range of hardness. PU with Steel mesh not only ensure the sheet flexibility and shock resistance, but also significantly reduce the sheet aging and extending the lifespan.
- It widely used in port, granary chute as buffer board and lining panel, also can be used as small chute. It has low noise, long service life and significantly reduce the breakage rate of material during transportation.

Item	Length (mm)	Width (mm)	Thickness (mm)	Outer Diameter (mm)
Sheet	≤6000	≤2000	5~50	/
Sheet with steel wire	≤4000	≤2000	10~20	/
Rod	≤1000	/	/	≤500

Polyurethane plate mounting special Bolt

Model	D	d	L	L1
M8*25	26	M8	35	25
M8*30	26	M8	40	30
M10*30	28	M10	40	30
M10*35	28	M10	45	35
M10*40	28	M10	50	40

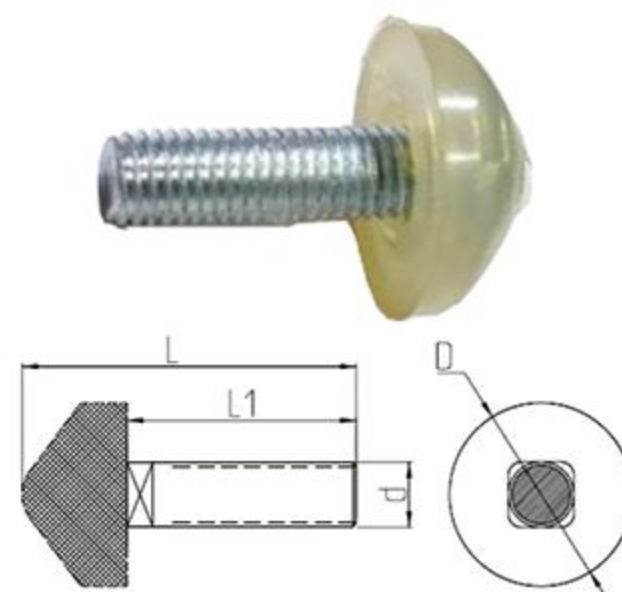

PU CASTING Tube

- The structure through special equipment, in the galvanized carbon steel or stainless steel chute wall, by centrifugal pouring way, uniform pouring of a layer of special formula polyurethane material. polyurethane elastomer in steel tube perfect fusion.
- The product has high wear resistance, impact resistance and antistatic properties. The hardness can be adjusted in a wide range, which effectively alleviates the impact wear of particles on the chute pipe. The wear resistance of polyurethane is more than 4 times that of ordinary polyurethane.
- The product extends the service life of the equipment, ensures the long-term stable operation of the equipment, effectively avoids the chute pipe bending phenomenon under the action of stress.



- Therefore, it is widely used in ports, transit warehouses and rice transportation. It has the advantages of low running noise, long service life and significantly reducing the crushing rate of materials.
- It not only saves installation time, but also reduces the difficulty of installation for workers, as well as the difficulty of inspection and detection of special parts.
- Its antistatic effect is good, can effectively prevent material friction caused by chute surface accumulation. Eliminate the hidden danger of dust explosion caused by electrostatic discharge.

Outer Diameter (mm)	PU Thickness (mm)	Steel Tube Thickness (mm)	Length (mm)
127	4, 5	1.5	1500
159	4, 5	1.5	1500
200	4, 5	1.5	1500
219	4, 5	1.5	1500

MC Nylon Tube/Rod/Sheet

- Cast nylon is a nylon material that aggregates low molecular compounds in the casting process. Because the polymerization reaction is synchronous with the forming process, the polymerization time can be extended sufficiently, make molecular weight large enough. And add oil in addition to retaining nylon weight light, easy to cut, high strength, wear resistant and other features, it also has good self-lubricating, high impact force and crumpling resistance characteristics.
- They are widely used in machinery manufacturing industry, like make all kinds of bearings, gears, shaft sleeves, friction plates, bearing block and so on.



Item	Length (mm)	Width (mm)	Thickness (mm)	Outer Diameter (mm)
Sheet	≤2050	≤1050	6~100	/
Rod	≤1000	/	/	10~250
tube	≤1000	/	/	40~300

PTFE Sheet/Rod/Tube

- Can be made from injection moulding or extrusion. Best chemical corrosion resistance, dielectric property.
- High temperature resistance among known plastic material. Lowest friction coefficient among known solid material.
- Works (noload) in the temperature range of -180℃~+260℃.



Item	Length (mm)	Width (mm)	Thickness (mm)	Outer Diameter (mm)
Sheet	≤1500	≤1500	1~60	/
Rod	≤1000	/	/	4~1600
Stripe	≤1000	/	/	40~300
tube	≤300	/	/	24~100

Conveyor Belt

- The product is suitable for conveying bulk or bagged materials with large loose density.
- Implementation standard: GB/T7984 2001 & DIN 22102.
- The skeleton material is EP polyester fiber with high strength and low shrinkage. The finished product has high dimensional stability, the extension of the band body during use is small, and the start is smooth, whether it is suitable for long distance or short distance conveying occasions.
- The inner layer of the conveyor belt has high bonding performance, which avoids the phenomenon of belt body layering and rubber surface falling off during use, and prolongs the service life.
- It has good fluting and flexibility, and the weight per unit length is reduced, which can significantly reduce the energy consumption of the equipment.
- Good wear resistance, biological corrosion resistance, can greatly reduce the cost of use, and ensure the continuity of production.

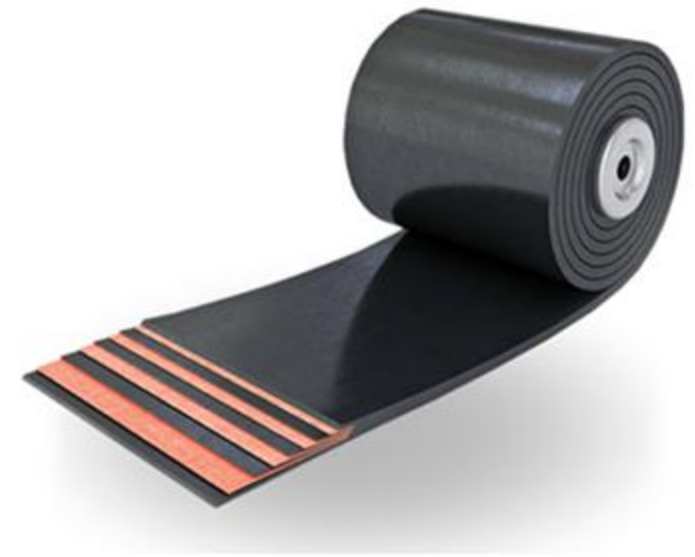

How to Order

Type	Features	Application	Extra Technical Requirements
Cotton Conveyor Belt	1. Cotton (Polyester Cotton) canvas woven carcass consists of cotton fiber in both warp and weft directions; 2. Superior flexibility and trough ability with low cost.	1. Mainly used in short/medium-distance conveying. Suitable for conveying small particles and powder-like materials such as wood chips, grains, coal, cement etc. 2. Working Temperature: -30℃ ~ 60℃.	/
Polyester Conveyor Belt	1. Canvas woven carcass consists of polyester Warp and poly amide weft. The belt contains slow elongation (in warp) and good trough ability (in weft) features. 2. Good water-resistance. No strength loss in wet condition. The belt will not get mouldy. 3. High strength, fatigue resistant, impact resistant, anti-tearing, long service life.	1. Widely used in long-distance conveying with heavy-duty materials. 2. Impact resistant and anti-tearing belt is normally used to handle high density materials in conveyor loading points or transfer points where the drop height are more than one meter.	/
Flame Retardant Conveyor Belt	1. The belt is flame retardant with specially treated belt carcass. 2. Cover rubber has good abrasion resistant and anti-static features	Suitable for conveying materials that require flame resistance and static conductivity under high-level safety requirements.	Flame Retardant K2: The overall persistence of flame of 6 samples with rubber cover should not exceed 45 seconds; The persistence of flame of any single sample should not exceed 15 seconds.
Oil Resistant Conveyor Belt	1. Carcass can be made from Polyester EP, Nylon NN, Cotton CC, or Polyester Cotton TC. 2. The different features of oily materials determine the selection of rubber cover. The correct selection of cover will lead to longer belt service life.	Mainly used in conveying different oily material at vegetable oil plant, mineral oil plant etc.	#3 oil, 70℃x72h Moderate Oil Resistant: suitable for wood oil, grain oil, animal oil, vegetable oil etc. Superior Oil Resistant: suitable for mineral oil, heavy oil, anti-rust oil, engine oil etc.
Acid-Alkali Resistant Conveyor Belt	1. Carcass can be made from Polyester EP, Nylon NN, Cotton CC, and Polyester Cotton TC. 2. Good overall adhesiveness, excellent physical and chemical corrosion resistance.	Mainly used in conveying acid or alkali material in chemical factory, fertilizer factory, paper mill, mining plant etc.	Soaking Temp. & Time: 50℃*96h A1: Solution HCl, Concentration 18%, A2: Solution H2SO4, Concentration 50%, A3: Solution NaOH, Concentration 48%,
Heat Resistant Conveyor Belt	1. Carcass can be made from Polyester EP, Cotton CC, and Polyester Cotton TC with high strength and low shrinkage features. 2. Both top and bottom rubber covers are thick and heat/high temperature resistant	Suitable for conveying sintered ore, cokes, cement clinker in metallurgical and building materials industries.	T1: Working temperature is no more than 100℃ T2: Working temperature is no more than 125℃ T3: Working temperature is no more than 150℃ T4: Working temperature is no more than 175℃, short-term peak temperature at 230℃.
Cold Resistant Conveyor Belt	1. Carcass can be made from Polyester EP, Nylon NN, Cotton CC, and Polyester Cotton TC. 2. Adopting lower crystal rubber materials (combination of natural and butadiene rubber) as cover rubber which contain high elasticity, shock resistance and cold resistance features.	Suitable for outdoor materials conveying in freezing areas or used at cold storage warehouses etc.	Cold resistance consists of two types: C1: Temperature range are -45~+50℃ C2: Temperature range are -60~+50℃
Patterned Conveyor Belt	1. Carcass can be made from Polyester EP, Nylon NN, Cotton CC, and Polyester Cotton TC; 2. Patterned Belt include various patterns such as "Cross", "V", "Dotted", "Crescent", etc. 3. Suitable for incline conveying.	Excluding the pattern measurements, the belt specifications and rubber cover properties of patterned conveyor belt remain the same as the flat conveyor belt under the condition of same carcass materials and application environments.	1: Dotted Type 2: Grooved Type 3: Cross Convex Type 4: Chevron Type

Technical Requirements

Comply with CEMA/RMA、AS、GB standards for rubber conveyor belt.

Overall Specifications

Item		Unit	Index Value	
			Cotton Conveyor Belt	Polyester Conveyor Belt
Carcass Material		/	Cotton CC-56	EP80 ~ EP400
No. of Plies		/	2~6	2~6
Tensile Strength		N/mm	112~420	160~2400
Elongation @ 10% Tensile Strength Adhesion		%	≤ 4	≤ 2
Strength	Ply to Carcass Ply	N/mm	≥ 3.2	≥ 4.5
Carcass	Cover to Carcass Ply	N/mm	≥ 2.7	≥ 3.5
Width		mm	300 ~ 2000	300 ~ 2000
Length		m	≤ 250	≤ 250

Cover Rubber Properties

Type	Tensile Strength	Elongation @ Break	Abrasion Loss
	MPa	%	mm3
Normal Condition	≥ 15.0	≥ 350	≤ 200
Heavy Abrasive Condition	≥ 18.0	≥ 400	≤ 100
Heavy Tearing Condition	≥ 24.0	≥ 450	≤ 120

Patterned Conveyor Belt Technical properties

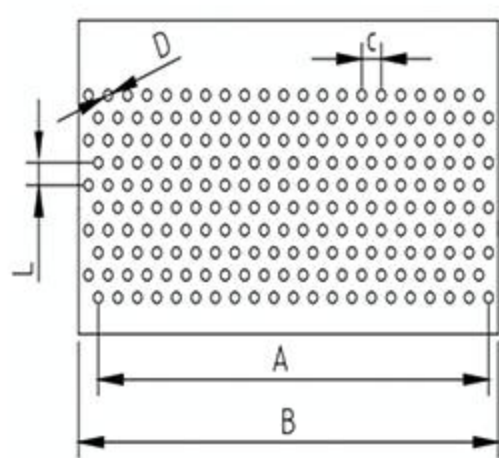

Dotted Type

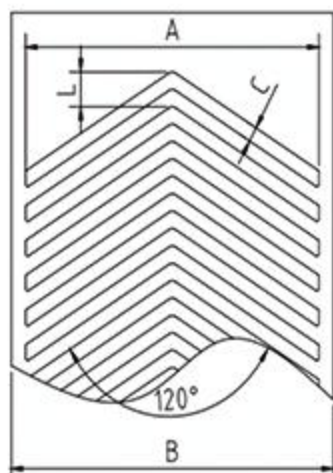

Grooved Type

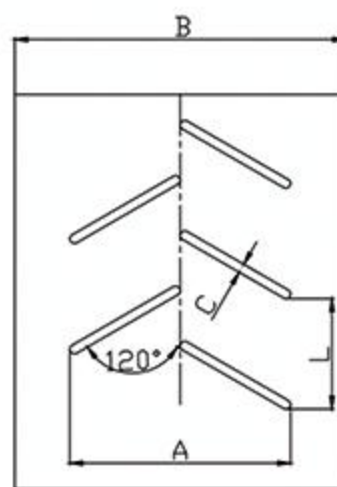

Cross Convex Type

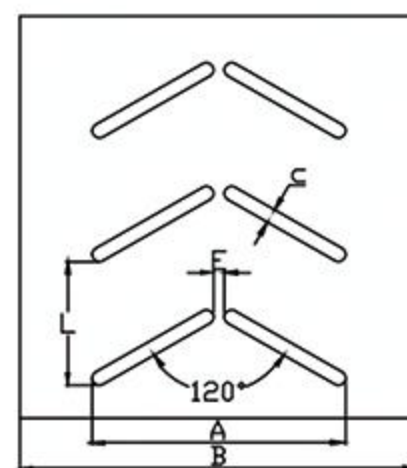

Chevron Type

Type	Pattern Width A(mm)	Belt Width Range B(mm)	C (mm)	D (mm)	Pattern Distance L(mm)	Pattern Depth (mm)	Pattern Angle
Dotted	430	500~650	20	10	20	3	/
Grooved 1	460	500~900	20	/	40	2.5	120
Grooved 2	580	650~900	20	/	40	2.5	120
Grooved 3	750	800~900	25	/	55	2.5	120
Cross Convex 1	450	500~900	25	/	300	6	120
Cross Convex 2	600	650~900	25	/	300	6	120
Chevron 1	700	750~1000	40	30	300	18	120
Chevron 2	900	950~1200	40	30	300	18	120

Light & Thin Conveyor Belt

- Carcass of Belt can be made from Polyester , Cotton CC.
- Colloid under different applications: PVC, PU, Silica Gel
- Top cover classifications under different surface shapes: flat belt and patterned belt.



Plat

Diamond

Grass

Skid Proof

Letter



Mesh

Back side 1

Back side 2

Dam board Belt

Skirt Belt

Patterned	Colloid Material	Width mm	Thickness mm	Carcass number	Colloid number	Colour
Plat	PVC PU Silica Gel	50-3000	1	1 2 3	1 2 3	green
Diamond			2			blue
Grass			3			white
Skid Proof			4			Black
I Letter			5			Customization
Customization						

Dam board Belt	Dam board thickness	Dam board Width	board Distance	Colour
	10~20 mm	20~45 mm	300~600mm	Green/blue
Skirt Belt	Skirt Height	Skirt Width	Skir Distance	Colour
	5~10 mm	45 mm	54 mm	Green/blue

Belt joint form selection

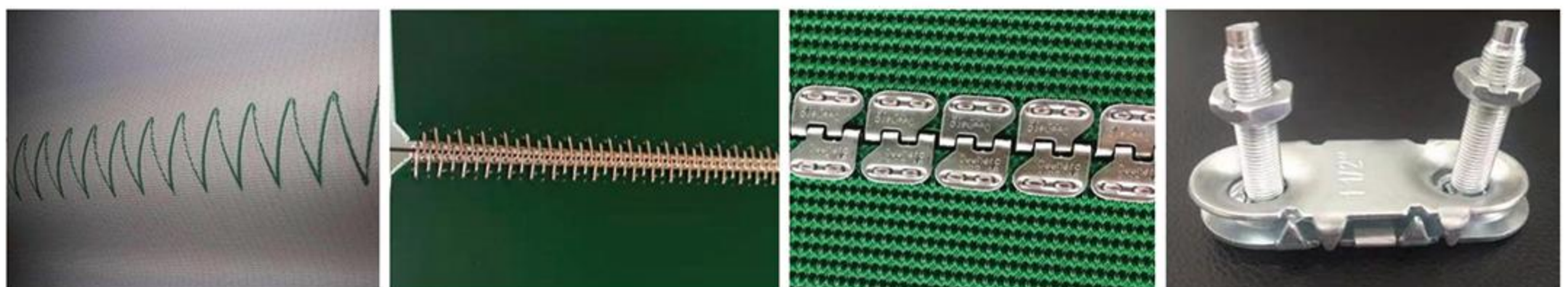

Hot Melt Tooth Joint

Wolf's Tooth Buckle

Butterfly Buckle

Splint Buckle

Continuous Screw Flight

Material: Carbon Steel

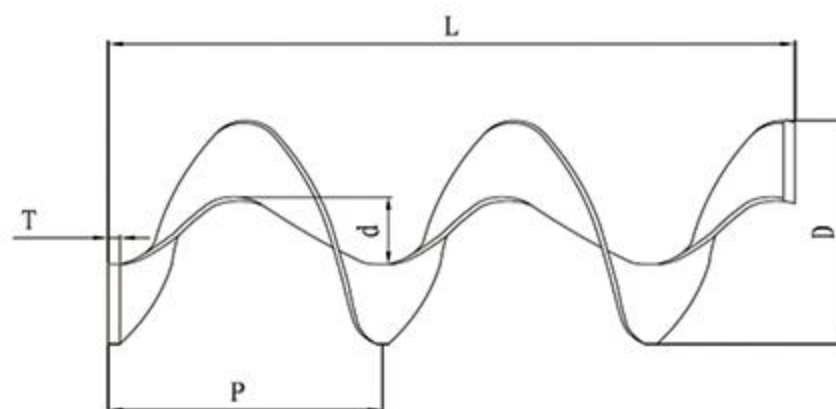

- The continuous cold rolling blade overcomes the shortcomings of the traditional screw blade production process, such as poor accuracy, difficult formation, large loss and low production efficiency.
- After forming, the blade surface is clean, the radial vertical degree is high, the dimension accuracy and the surface hardness are high, can effectively reduce the resistance of the spiral propulsion. Product rigidity, easy to weld and assemble and can be customized according to the length and diameter of customers.

Type	Pitch P (mm)	Max. Outer Diameter D(mm)	Min. Inner Diameter d(mm)	Band Thickness T(mm)	Max O.D./I.D. Rati
LY125	100-125	φ125	φ30	3.5	≤4
LY160	120-160	φ160	φ42	3.5	≤4
LY200	160-200	φ200	φ48	3.5	≤4
LY250	200-250	φ250	φ60	3.5-5	≤4
LY320	250-320	φ320	φ76	3.5-5	≤4
LY400	320-400	φ400	φ108	3.5-5	≤4
LY500	400-500	φ500	φ133	3.5-5	≤4

Note: When the inner diameter of the customized specification is in the range of the minimum inner diameter +5mm, the maximum outer diameter of the customized specification cannot exceed 3 times of the inner diameter

Selection reference principle

Max. Band Width (D-d)/2 (mm)	Pitch/O.D. Ratio	Max. Outer Diameter D(mm)	Min. Inner Diameter d(mm)	Band Thickness T(mm)	Max O.D./I.D. Rati
165	0.6-1.3	500	20	3	≤4
165	0.6-1.3	500	25	4	≤4
165	0.8-1.3	500	28	5	≤4
165	0.8-1.2	500	40	6	≤4

Note: The thickness of the outer circle of the blade is about 50% of the thickness of the inner hole plate

Sectional Screw Flights

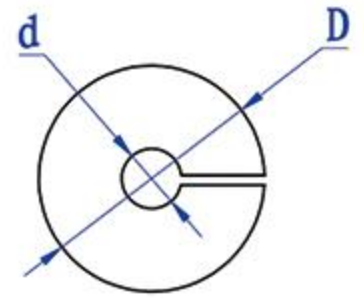
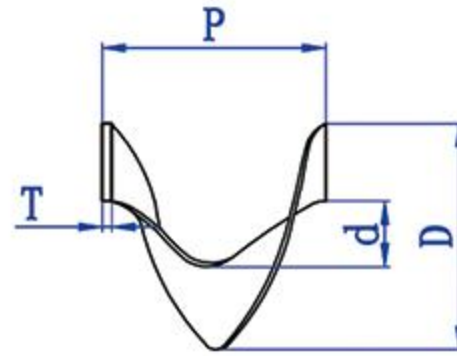

- Material: Carbon Steel, Low Alloy Steel, Wear Resistant Steel, Stainless Steel, etc.
- It solved the problem that the continuous cold rolling is difficult to control in large diameter, large thickness and special size and difficult to forming in High carbon steel, alloy steel, stainless steel materials.
- It is single pitch shape, the inner and outer thickness are same. The out diameter, inner diameter and pitch can be exactly produced according to customer' s need.

Pitch P mm	Pitch/O.D. Ratio	Max. Outer Diameter D mm	Min. Inner Diameter d mm	Band Thickness T mm	Max O.D./I.D. Rati
60~100	≤1.00	480	25	3-16	≤4.0
100~150	≤1.25	480	30	3-18	≤4.0
150~200	≤1.33	520	50	3-20	≤4.0
200~250	≤1.43	630	60	3-25	≤3.8
250~300	≤1.43	670	65	3-25	≤3.8
300~350	≤1.43	900	90	3-30	≤3.8
350~400	≤1.43	950	90	3-30	≤3.6
400~450	≤1.43	950	95	3-30	≤3.6
450~500	≤1.43	1150	135	3-35	≤3.6
500~550	≤1.43	1300	150	3 ~ 40	≤3.6
550~650	≤1.43	1350	150	3 ~ 40	≤3.3
650~750	≤1.43	1400	200	3 ~ 45	≤3.3
750~850	≤1.43	1450	200	3 ~ 50	≤3.3
850~950	≤1.43	1450	250	3 ~ 55	≤3.3
950~1050	≤1.43	1500	300	3 ~ 55	≤3.3
1050~1200	≤1.47	1600	350	3 ~ 55	≤3.0
1200~1250	≤1.47	1800	400	3 ~ 55	≤3.0
1250~1400	≤1.47	2000	450	3 ~ 55	≤3.0
1400~3000	≤1.50	3000	480	3 ~ 60	≤3.0

Note: 1. When the thickness of spiral blade is 20-30mm, the blade width shall not be greater than 400mm

Note: 2. When the thickness of spiral blade is 30-40mm, the blade width shall not be greater than 370mm

Note: 3. When the thickness of spiral blade is 40~50mm, the blade width shall not be greater than 350mm

Sieve Cleaner and Pan Cleaner

Material: Polyurethane

Sieve Cleaner



Small Triangle (QA15)

Unique outline and convex center, easy to bounce on sieve.



Big Triangle (QA26)

Unique outline and convex center, easy to bounce on sieve.



Rivet Triangle (QD21)

Center rivet design let it contact with sieve pore to get better bounce as well as easier movement.



Brush Triangle (QM25)

The design not only provides bouncing on sieve, but also cleaning it at the same time. It greatly improves the final cleaning effect.



Cotton Canvas Pad (QB32)

The cotton design provides good protection to the sieve for getting long working lifespan



Big Brush (QMW42)

During the collision with the screen, the hair brush also plays a role in cleaning the screen, which greatly improves the cleaning efficiency. It has the function of cleaning block and pushing block, good practicability and good use effect.

Pan Cleaners



Crisscross Type (TS32)

Unique outline and convex center, easy to bounce on sieve.



Diamond Type (TL42)

Keeping original shape and flexibility even used for a long time. It's suitable for standard size sieve.



Rectangle Type (TF55)

Suitable for standard size sieve and minimize damage to sieve frame.



Quincunx Type (TM68)

Bigger shape suitable for bigger sieve.

Sieve Cleaning Balls



Natural Rubber



Silica Gel



PU

Comparison of Performance Parameters (NB, SILICON, PU)

	Natural Rubber	Silica Gel	PU
Hardness (Shore A)	55-85	55-85	70-85
Working Temperature °C	-25~+100	0~+220	-40~+120
Oil Resistance	Ordinary	Ordinary	Good
Bounce	Good	Ordinary	Ordinary+
Abrasion Resistance	Ordinary+	Good	Excellent
Rebound Rate	≥75%	/	/

Common specifications (Material: Rubber, Silica Gel, PU)

Diameter Φ mm	Quantity of Carton	Weight of Carton Kg	Size of Carton cm	Volume of Carton M ³
12	6000	7.8	32x32x32	0.017
16	3000	8.1	32x32x32	0.017
19	2000	9.2	32x32x32	0.017
22	1500	10.8	30*25*22	0.017
24	1000	9.4	30*25*22	0.017
26	1500	18.0	32x32x32	0.033
28	1200	18.0	32x32x32	0.033
30	1000	18.5	32x32x32	0.033
32	800	18.0	32x32x32	0.033
35	600	18.0	32x32x32	0.033
38	500	19.2	50X40X23	0.035
40	400	17.6	50X40X23	0.035
45	300	18.8	50X40X23	0.035
50	200	17.3	50X40X23	0.035
55	150	17.3	50X40X23	0.035
60	100	14.9	50X40X23	0.035

Partner 合作伙伴



version number : 202410

Head Office: 303 Yushan North Road, Jingkou District, Zhenjiang City, Jiangsu Province, China

Factory Address: Jinhe Road, Daoshu Industrial Park, Danyang City, Jiangsu Province, China

Tel: 86-511-88811566 85515333

Fax: 86-511-88818300 88859300

E-mail: market@jingweiss.com

Website: www.jingweiss.com